

T 2 & 3 N, R 28 E, W.M. UMATILLA CO. OR.

APPLICATION - MAP FOR CHESTER PRIOR
FOR A TRANSFER FROM

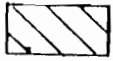

G-6069 TO TRANSFER
PLACE OF USE.



G-6069 TO ALSO
TRANSFER PLACE OF USE.

SCALE:
1" = 1320'



This map is for identifying
the location of water rights
only and is not intended to
show property lines or
dimensions.

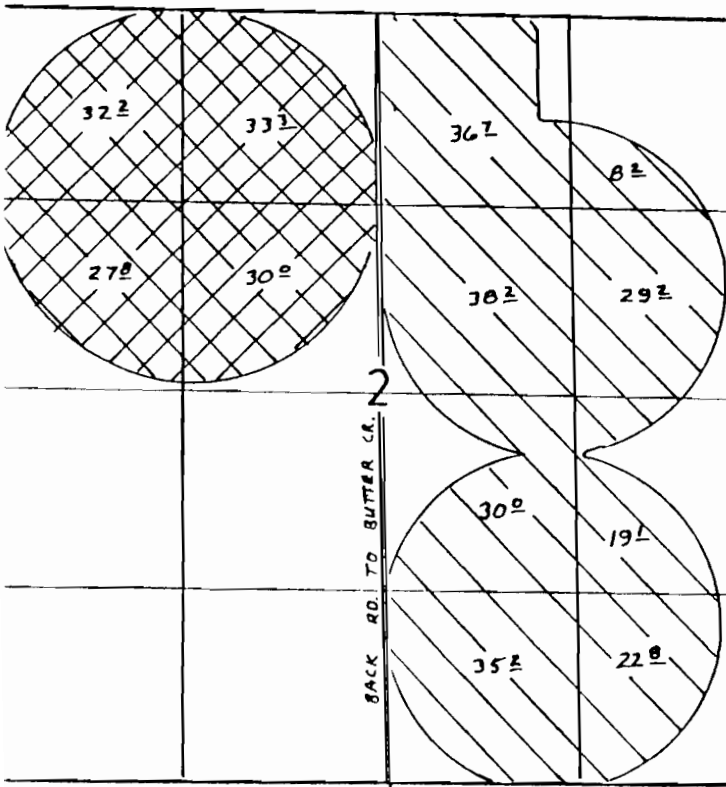
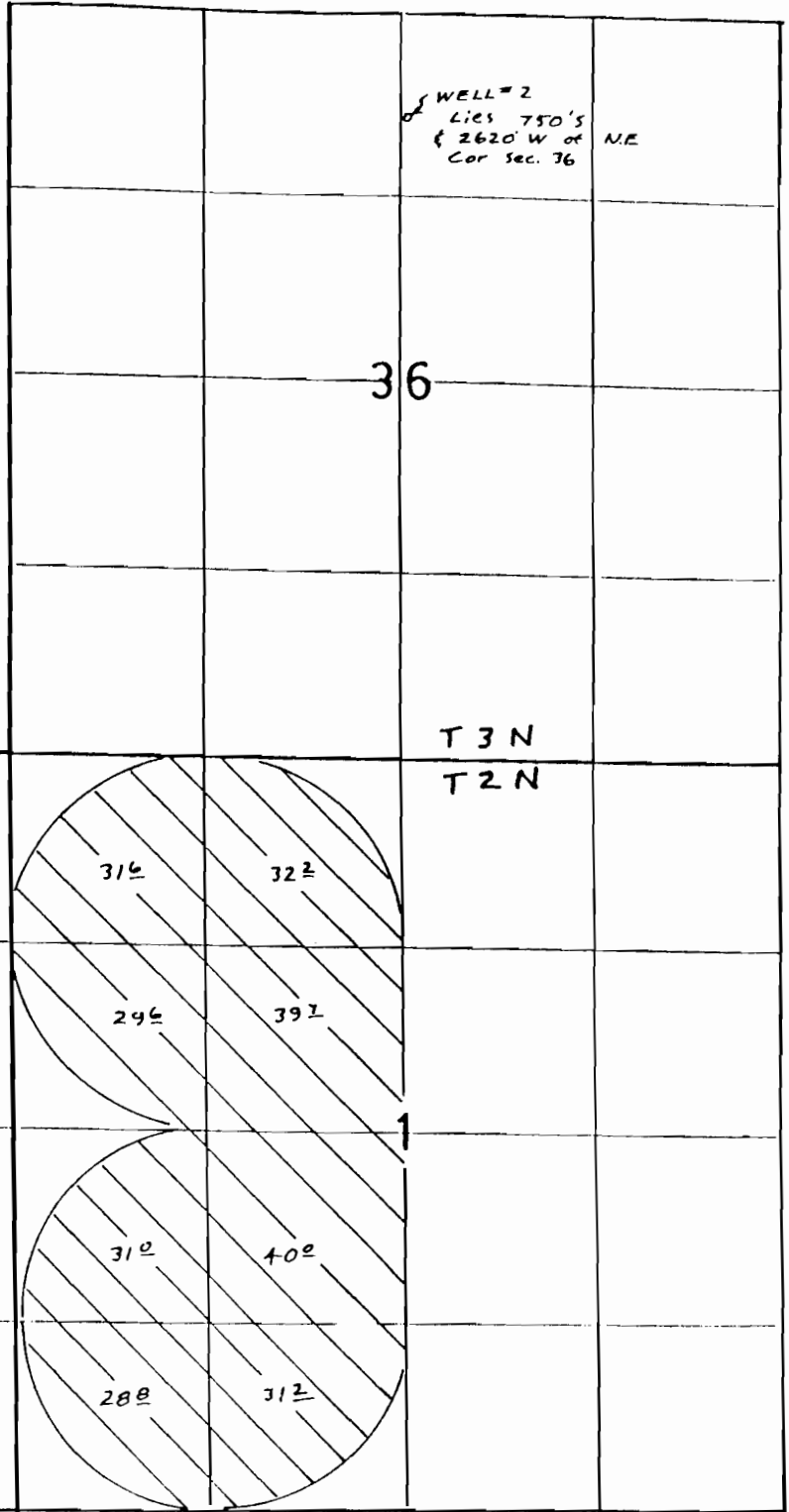

* need existing PODs ~ C 61532 (wells 4, 7 & 8)

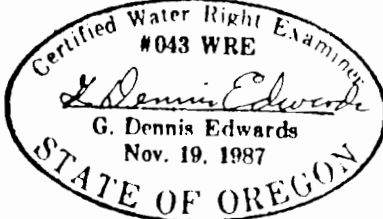

T-6690

T3N, R28E, W.M., UMATILLA CO. OR.

APPLICATION MAP FOR
CHESTER PRIOR FOR
A TRANSFER FROM

 G-5275 to Transfer Place of Use.

 G-5275 to Stay.

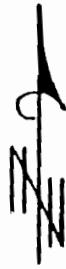
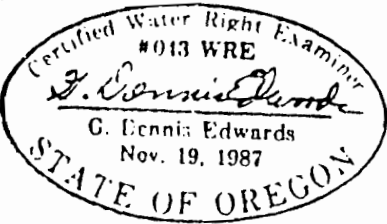

Scale: 1" = 1320'

This map is for identifying the location
of water rights only and is not intended
to show property lines or dimensions.

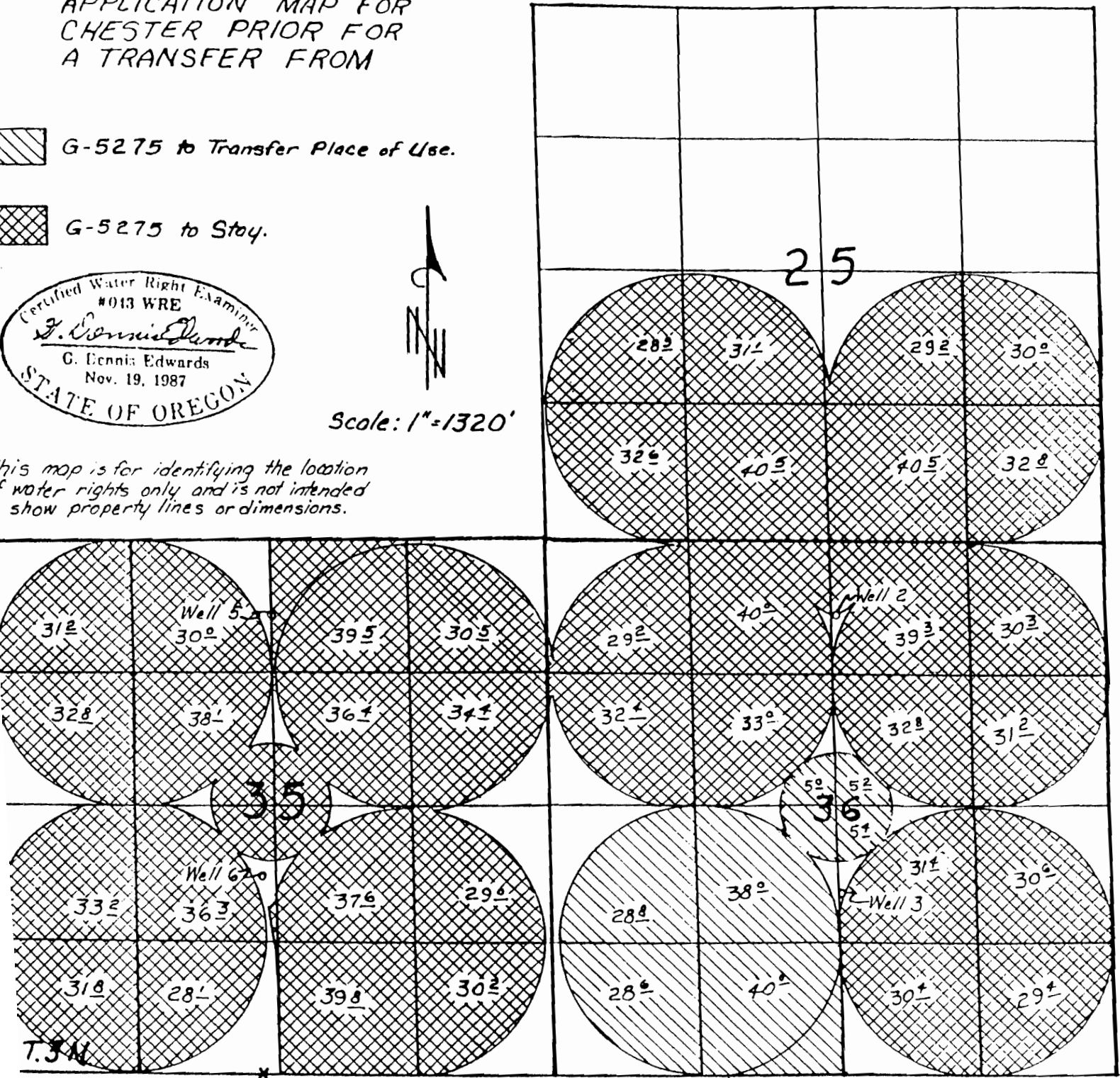

T 3 N
T 2 N
Wells Loc.: Well 2 - 750' S & 2620' W of N.E. Cor. Sec. 36, Well 3 - 1780' N & 2600' W
S.E. Cor. Sec. 36. Well 5 - 770' S & 2640' E of N.W. Cor. Sec. 35. Well 6 - 1940' N
2540' E of S.W. Cor. Sec. 35.

T-6690

REV. 11/21/91

Edwards Surveying P.O. Box 763
567-3336 Hermiston, OR. 97838
11/15/91 Job # W9005032-A