

T.6S. R.1W., W.M

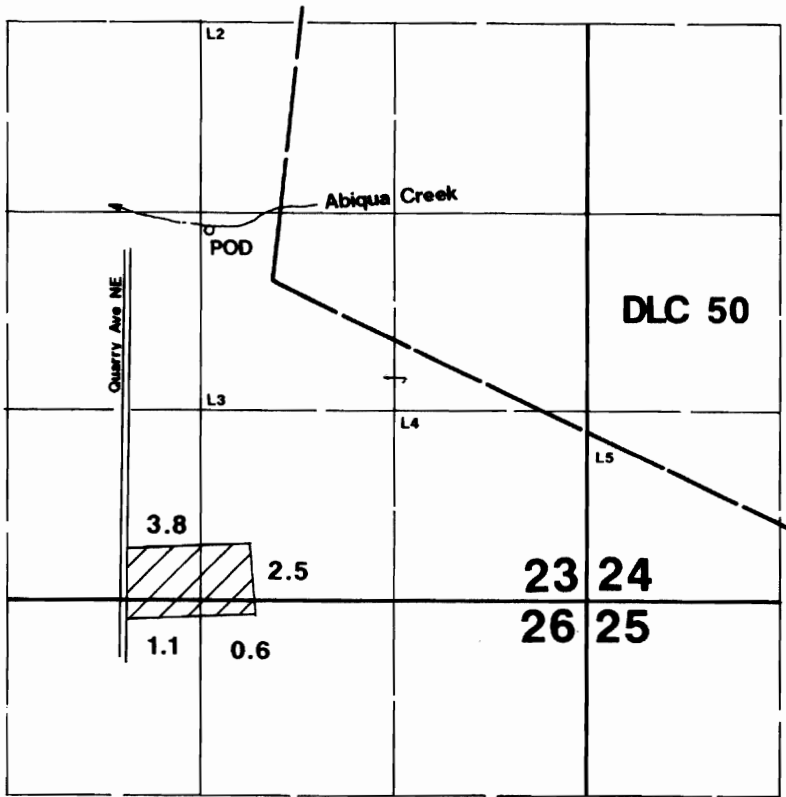

POD is located 2550'N & 2560'W from the SE corner of Section 23.

RECEIVED

MAR 03 1999

WATER RESOURCES DEPT
SALEM, OREGON

Final Proof Survey

Transfer #: T-6733

In Name Of

Pembroke Farms

Surveyed on February 3, 1999 by JM Schuette

This Map Was Prepared For The Purpose Of Identifying The Location Of A Water Right Only And Is Not Intended To Provide Legal Dimensions Or Location Of Property Ownership Lines.

