

T.9 S. R. I.W. W. M.

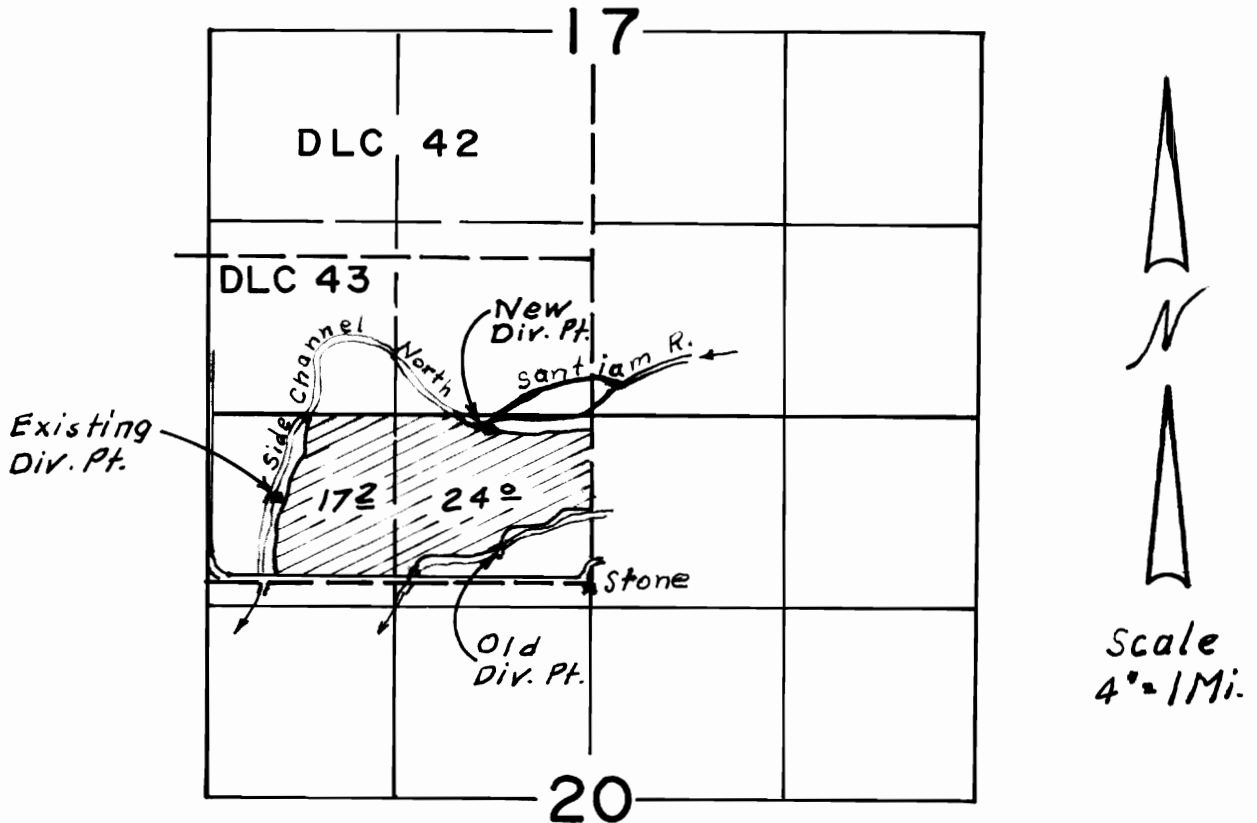

Old Div. Pt.: 200' N & 650' W from SE Cor. DLC 43
 New Div. Pt.: 1080' N & 740' W " " " " "
 Exist. Div. Pt.: 570' N & 2180' W " " " " "

FINAL PROOF SURVEY UNDER

Transfer No. 6853
 Application No. Permit No.
 IN NAME OF

WARREN S. & JANICE L. GRAY

Surveyed SEP. 16 1992, by
 Inspected MAY 5, 1997

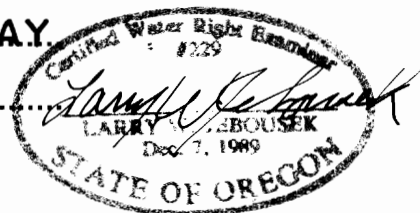

THIS MAP WAS PREPARED FOR THE PURPOSE OF IDENTIFYING THE LOCATION OF A WATER RIGHT ONLY AND IS NOT INTENDED TO PROVIDE LEGAL DIMENSIONS OR LOCATION OF PROPERTY OWNERSHIP LINES.

WAC Aerial Photo