

T.5S., R.2W., W.M.

RECEIVED

OCT 19 1997

WATER RESOURCES DEPT.
SALEM, OREGON

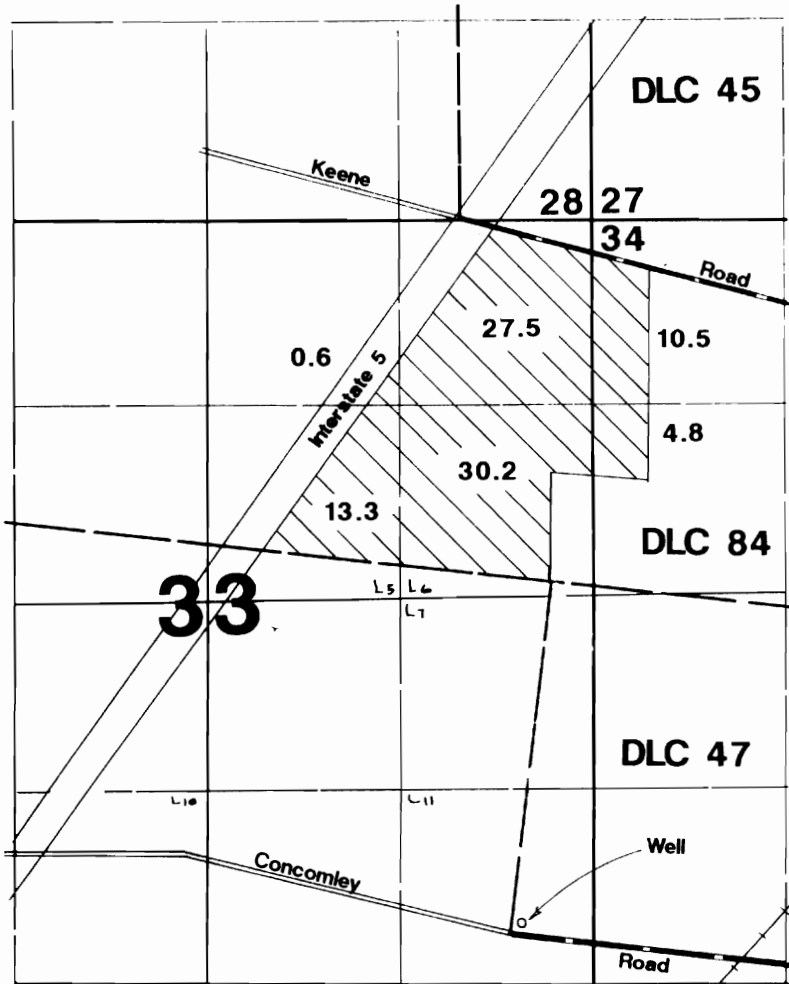

Well located 70'N & 80'E from SW corner DLC 47.

Final Proof Survey

Transfer #: T-6879

In Name Of

James Butsch

Surveyed on September 28, 1997 by JM Schuette

THIS MAP WAS PREPARED FOR THE PURPOSE OF IDENTIFYING THE LOCATION OF A WATER RIGHT ONLY AND IS NOT INTENDED TO PROVIDE LEGAL DIMENSIONS OR LOCATION OF PROPERTY OWNERSHIP LINES.

