

RECEIVED

JAN 31 1997

WATER RESOURCES DEPT.
SALEM, OREGON

T. 4 N., R 27 E., W.M.
SCALE 1" = 1320'

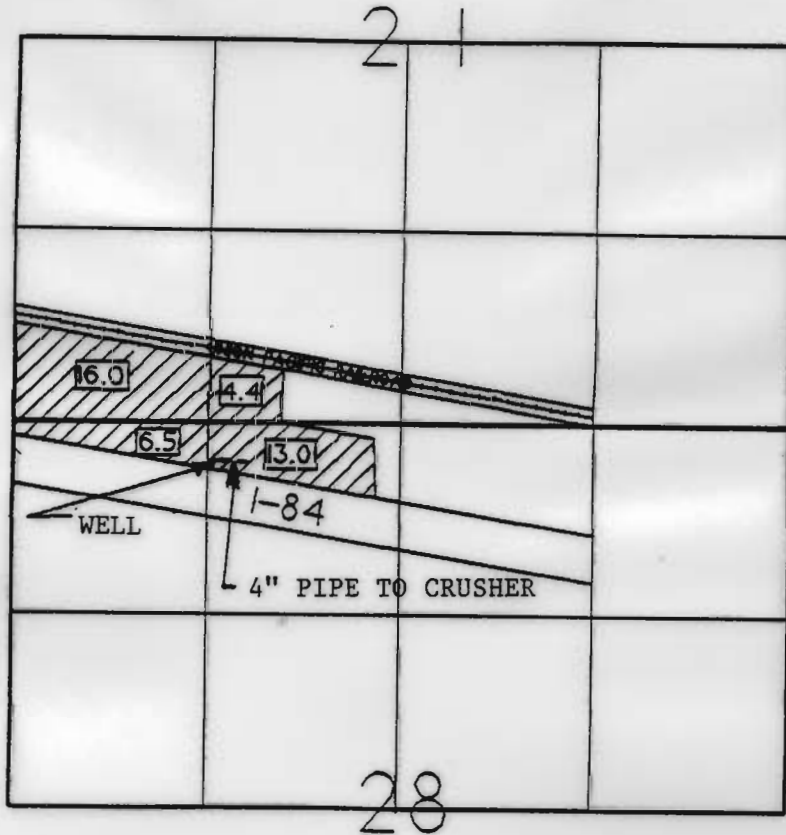

WELL LOC. 4940' N & 1350' E FM SW CORNER SECTION 28

**FINAL PROOF SURVEY
UNDER**

PERMIT NO. T-7105

IN NAME OF

JEDEDIAH AYLETT

The preparation of this map is for the purpose of identifying the location of water rights only, and has no intent to provide dimensions or locations of property ownership lines.

