

T.6S. R.2W., W.M

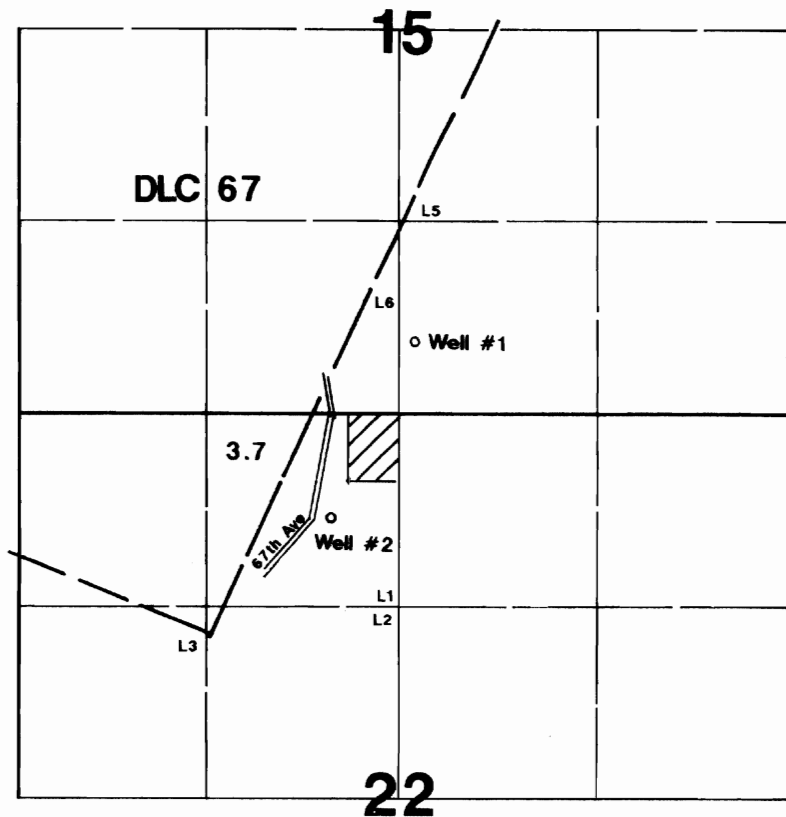

Well #1 is located 500'N & 2530'W from the SE corner Section 15.
Well #2 is located 750'S & 470'W from N1/4 corner of Section 22.

Final Proof Survey

Transfer #: T-6898

In Name Of

Greg Bennett

Surveyed on September 9, 1998 by JM Schuette

RECEIVED

SEP 30 1998

WATER RESOURCES DEPT
SALEM, OREGON

This Map Was Prepared For The Purpose Of Identifying The
Location Of A Water Right Only And Is Not Intended To Provide
Legal Dimensions Or Location Of Property Ownership Lines.

