

RECEIVED

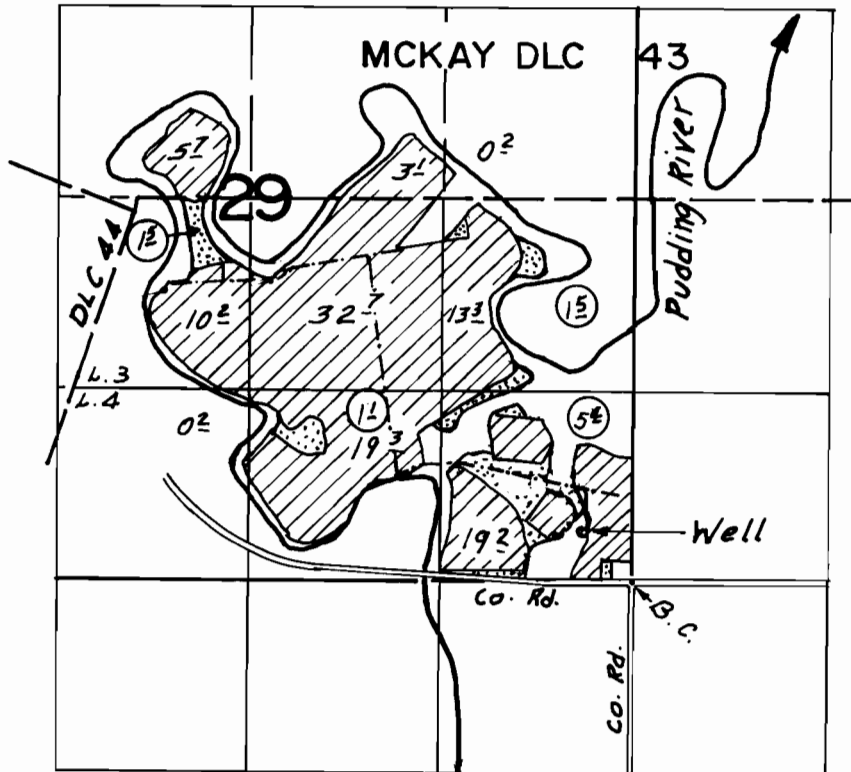

DEC 31 1997

T.5S. R.1W., W.M.

WATER RESOURCES DEPT
SALEM, OREGON

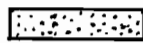

Well Loc.: 235'N & 325'W From SW Cor. Sec.29

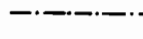
-  Primary (ac)
-  Supplemental
-  6" PVC Pipe

FINAL PROOF SURVEY UNDER

Transfer No. T- 6964
Application No. G-13382 Permit No. G-11758..
IN NAME OF

DAVID...OBERSINER.....

Surveyed Aug. 13, 1997, by ..

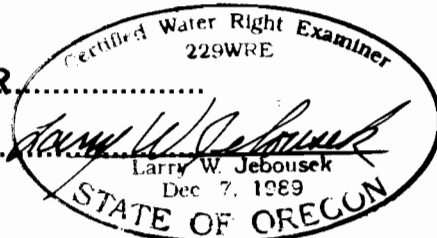

THIS MAP WAS PREPARED FOR THE PURPOSE OF IDENTIFYING THE LOCATION OF A WATER RIGHT ONLY AND IS NOT INTENDED TO PROVIDE LEGAL DIMENSIONS OR LOCATION OF PROPERTY OWNERSHIP LINES.

WAC-MARION Co.-92 7C-6 Photo