

RECEIVED

OCT 01 1998

WATER RESOURCES DEPT.  
SALEM, OREGON

SW1/4NW1/4 SEC. 20, T13S, R29E.

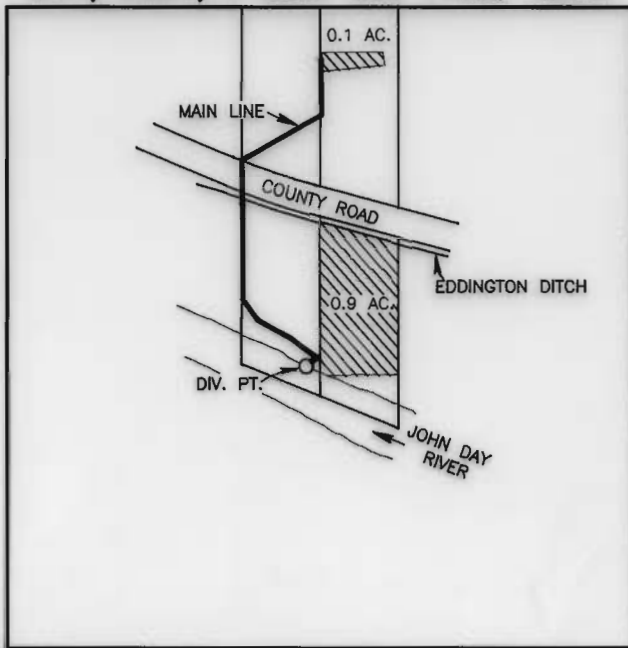

SCALE 1"=400'

DIVERSION POINT IS 590' N. AND 630' E. OF THE W1/4 COR.

**FINAL PROOF SURVEY  
UNDER**

TRANSFER NO. 7138  
SPECIAL ORDER VOL. 49, PAGE 263

IN NAME OF  
MAX AND IRENE FERGUSON

SURVEYED AUGUST 28, 1998 BY ROBERT D. BAGETT

NOTE: The preparation of this map was for the purpose of identifying the location of the proposed water right and has no intent to provide dimensions or location of property ownership lines.

