

T. 7S., R. 38E., W.M.

RECEIVED

SEP 24 1998

WATER RESOURCES DEPT
SALEM, OREGON

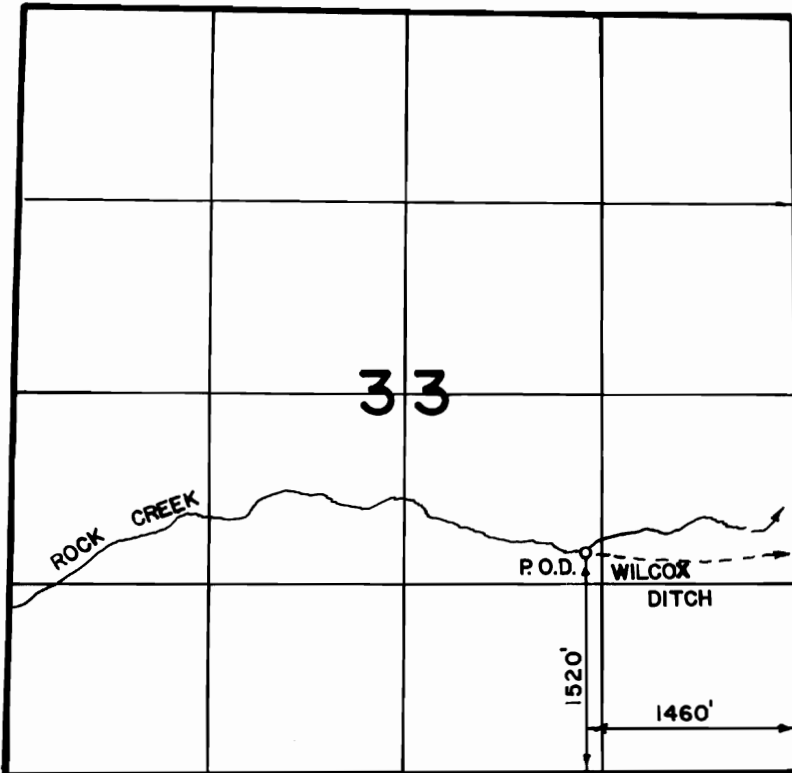

Scale 1" = 1320'

THE PURPOSE OF THIS MAP IS FOR IDENTIFYING THE LOCATION OF THE WATER RIGHT ONLY AND IS NOT INTENDED TO PROVIDE LEGAL DIMENSIONS OF PROPERTY OWNERSHIP LINES.

FINAL PROOF SURVEY

TRANSFER NO. 7155

IN NAME OF

James E. Kerns

SURVEYED SEPT. 6, 1998

