

T.4 S. R. I E. W.M.

RECEIVED
 NOV 17 1999
 RECORDS DEPT
 SALEM OREGON

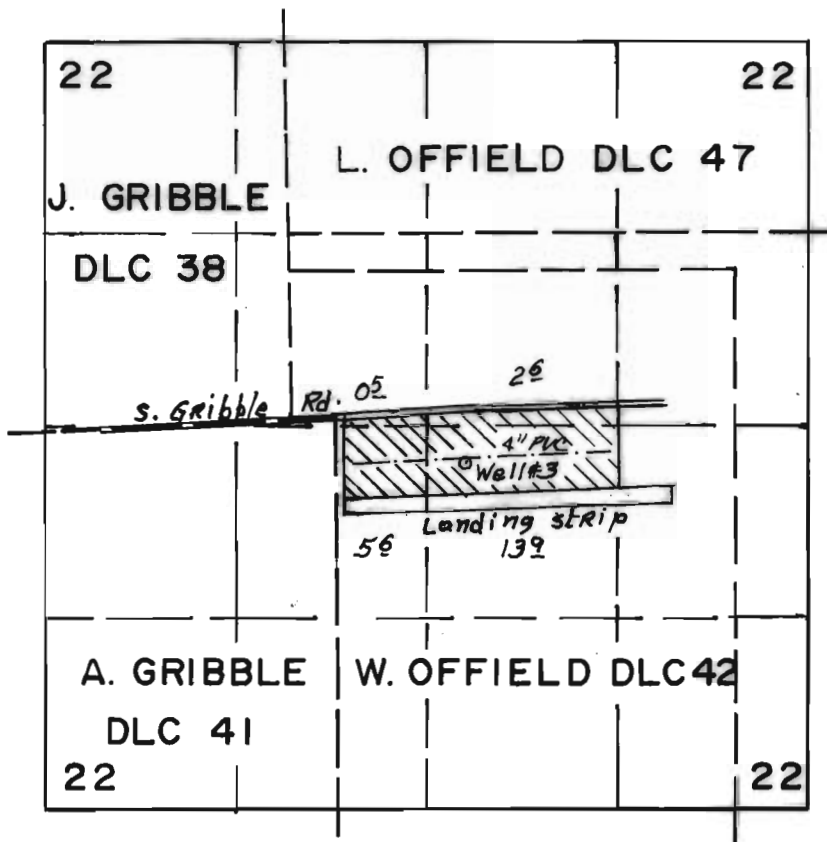

Scale
 4" = 1 Mi.

Well #3 loc: 290'S & 905'E From NE Cor. DLC 41

FINAL PROOF SURVEY UNDER

Transfer No. T-8037
 Application No. G-14093 Permit No. G-12872..
 IN NAME OF

WORKMAN'S AIRPARK WATER ASSOCIATION, INC.

Surveyed Sept. 15, 1999, by

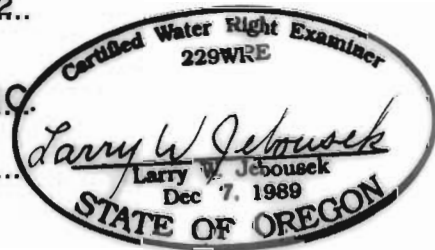

THIS MAP WAS PREPARED FOR THE PURPOSE OF IDENTIFYING THE LOCATION OF A WATER RIGHT ONLY AND IS NOT INTENDED TO PROVIDE LEGAL DIMENSIONS OR LOCATION OF PROPERTY OWNERSHIP LINES.