

T. 16 S. R. 4 W. W.M.

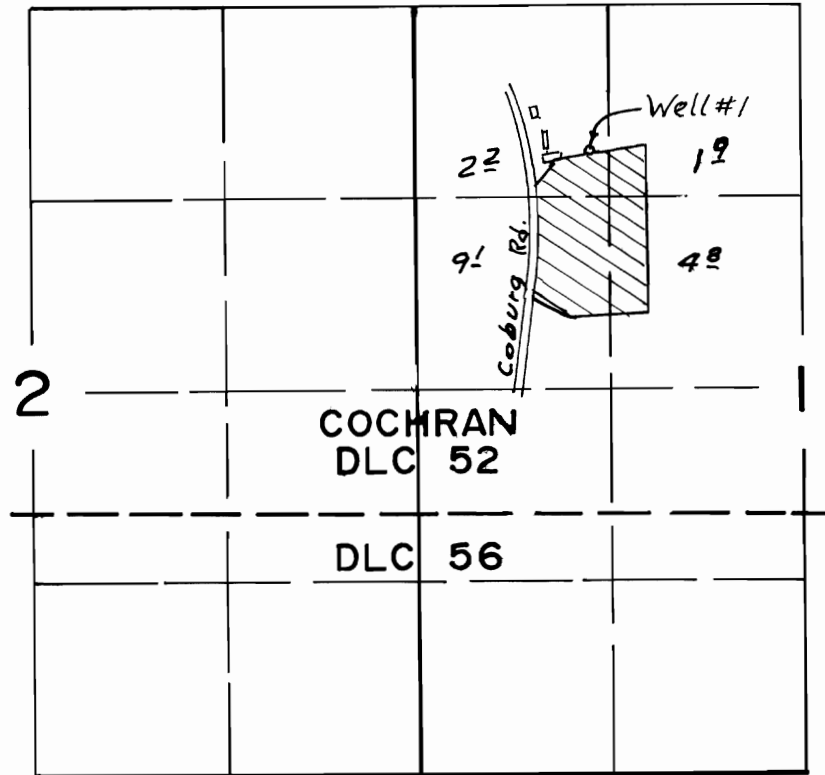

4" = 1 Mi.

Well #1 loc. 1010'S & 1170'E from NW Cor. Sec 1

RECEIVED

FINAL PROOF SURVEY

UNDER

T-7232 *deb*

TRANSFER NO. ~~T-7273~~

Application No. Permit No.

IN NAME OF

HAYWORTH FARMS, INC.

Surveyed Aug. 15, 2000, by

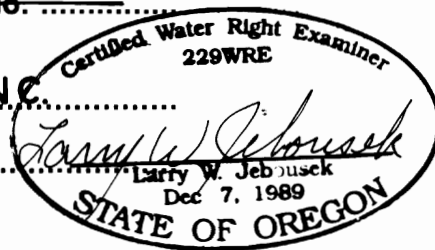

WATER RESOURCES DEPT
SALEM, OREGON

THIS MAP WAS PREPARED FOR THE PURPOSE OF IDENTIFYING THE LOCATION OF A WATER RIGHT ONLY AND IS NOT INTENDED TO PROVIDE LEGAL DIMENSIONS OR LOCATION OF PROPERTY OWNERSHIP LINES.