

CLAIM OF BENEFICIAL USE MAP
 TRANSFER: T-9055
 FOR
 24 RANCH, INC.

SECTION 15, TOWNSHIP 31 SOUTH
 RANGE 16 EAST, W.M., LAKE COUNTY, OREGON

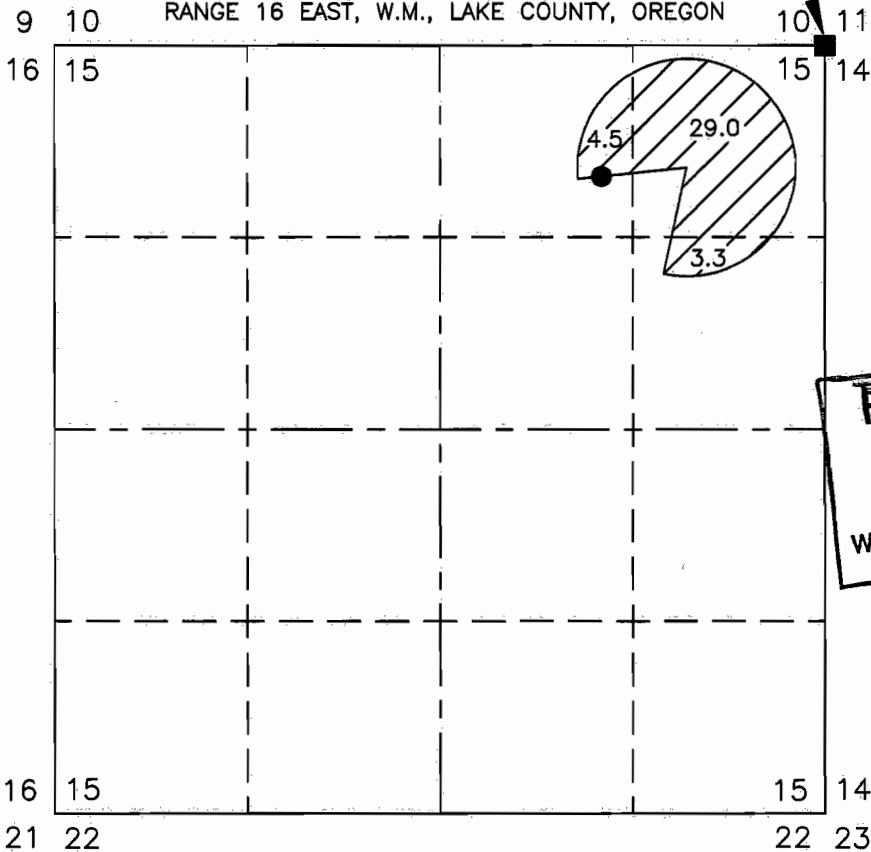

FOUND 1941
 GLO BRASS
 CAP.

RECEIVED
 DEC 06 2004
 WATER RESOURCES DEPT
 SALEM, OREGON

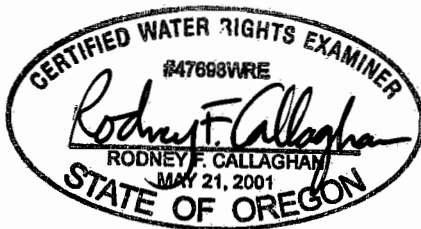

RE-NEW: 12/31/03

THIS MAP IS FOR THE PURPOSE OF
 LOCATING A WATER RIGHT AND HAS
 NO INTENT TO PROVIDE LEGAL
 DIMENSIONS OR THE LOCATION OF
 PROPERTY LINES.

LEGEND

● POINT OF APPROPRIATION, NEW WELL, LOCATED IN THE
 NW1/4 OF THE NE1/4 OF SECTION 15, 900 FEET
 SOUTH AND 1534 FEET WEST FROM THE NE CORNER
 OF SECTION 15.



36.8 ACRES BEING IRRIGATED FROM THE POINT OF
 APPROPRIATION AS SHOWN.

PREPARED FOR: 24 RANCH, INC.
 50615 HIGHWAY 31
 SUMMER LAKE, OR 97640

PREPARED BY:
 CALLAGHAN LAND SURVEYING
CLS 427 SOUTH H STREET
 LAKEVIEW, OR 97630
 (541) 947-5841

DATE: 8/27/2003 DRAWING: 200369