

FINAL PROOF MAP

SE 1/4 Section 29, T.39S. R.19E., W.M.

Lake County, Oregon

T-7253

JOHN YOCUM

FIVE

2000

WATER RESOURCES DEPT
SALEM OREGON



SCALE

1" = 1320'

TAX LOT 105

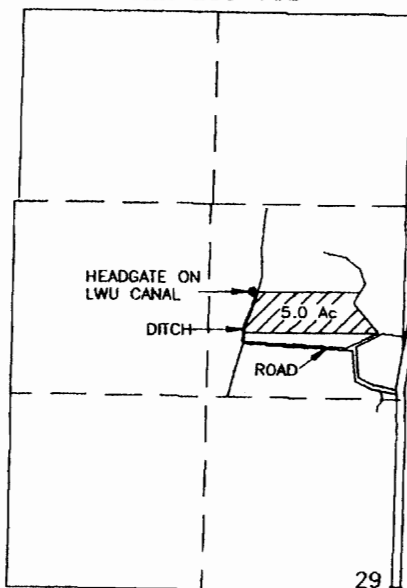

29 28 BRASS CAP
32 33 POB OF SURVEY

Survey by: Sundet & Associates
P.O. Box 1228
Lakeview, OR 97630
541-947-3293
June 2000 Drawing #11600b

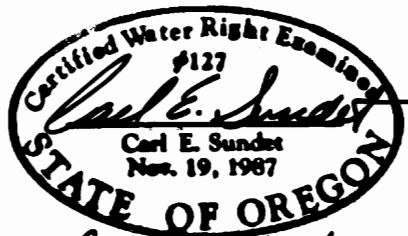

Renews 6/30/02

This map is for the purpose of identifying the location of the water right only and is not intended to provide legal dimensions or property ownership lines.