

T. 2N. & 3N., R. 26E., W.M.

MORROW COUNTY

SCALE 1" = 1320'

RECEIVED

SEP 30 1999

WATER RESOURCES DEPT.
SALEM, OREGON

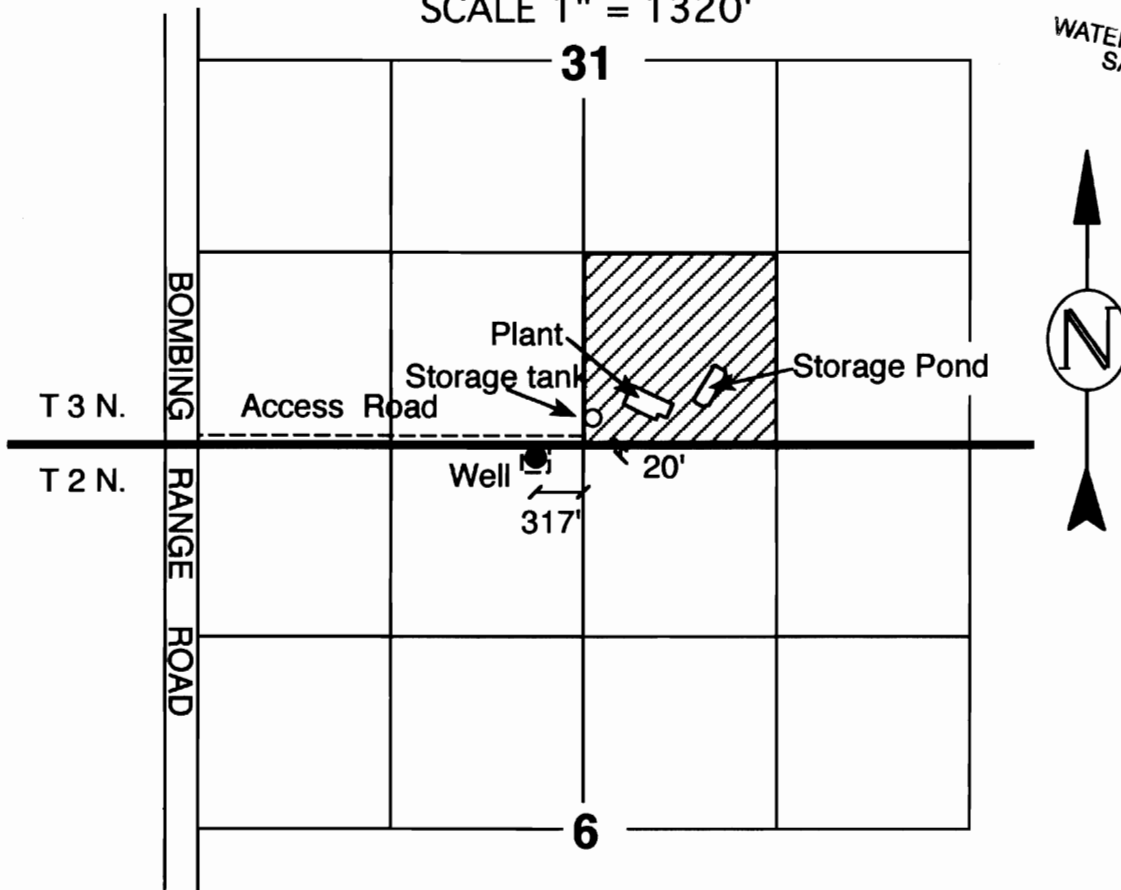

Well Located 20' South & 317' West of the South Quarter Corner Section 31, T3N, R26E.W.M.
NE 1/4 of NW 1/4 of Section 6, T2N, R26 E.W.M.

WATER RIGHTS PROOF MAP



INDUSTRIAL Water Use At This Location

IN NAME OF

Port of Morrow

THIS MAP IS FOR THE PURPOSE OF IDENTIFYING THE LOCATION OF WATER RIGHTS ONLY AND IS NOT INTENDED TO PROVIDE THE LEGAL DIMENSIONS OR LOCATIONS OF PROPERTY OWNERSHIP LINES.



ENGINEERING - LAND SURVEYING - WATER RIGHTS
R. V. McKINNIS ENGINEERING
 79980 Prindle Loop Road
 Hermiston, Oregon 97838
 (541) -567-2017