

T.6S., R.2 & 3W., W.M.

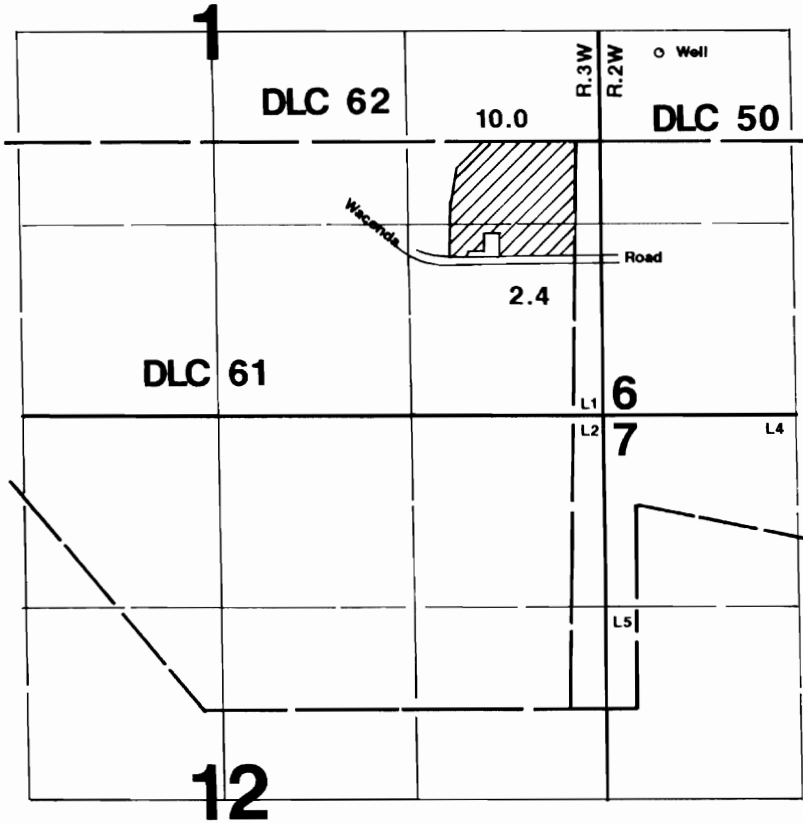

Well located 620'N & 620'E from NE corner DLC 61.

RECEIVED

NOV 26 1997

**WATER RESOURCES DEPT.
SALEM, OREGON**

Final Proof Survey

Transfer #: T-7269

In Name Of

Ted V. Bell

Surveyed on November 24, 1997 by JM Schuette

THIS MAP WAS PREPARED FOR THE PURPOSE OF IDENTIFYING THE LOCATION OF A WATER RIGHT ONLY AND IS NOT INTENDED TO PROVIDE LEGAL DIMENSIONS OR LOCATION OF PROPERTY OWNERSHIP LINES.

