

T.5S. R.1E., W.M.

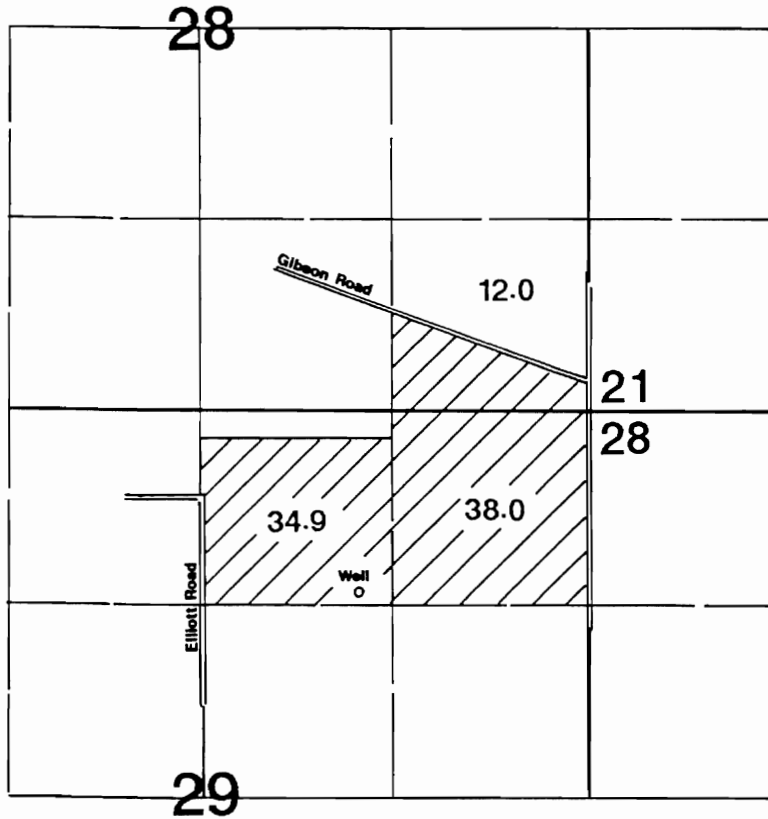

Well is located 1250'S & 1550'W from the NE corner of Section 29.

RECEIVED

SEP 24 1999

**WATER RESOURCES DEPT.
SALEM, OREGON**

Final Proof Survey

Transfer #: T-7313

In Name Of

James Butsch

Surveyed on September 18, 1999 by JM Schuette

This Map Was Prepared For The Purpose Of Identifying The Location Of A Water Right Only And Is Not Intended To Provide Legal Dimensions Or Location Of Property Ownership Lines.

