

FINAL PROOF MAP
 OF TRANSFER T-6970
 FOR L & L FARMS
 T3N R 28E WM
 UMATILLA COUNTY

Certified Water Right Examiner
 #333 WRE
Daniel K. Schorvick
 Date Given Schorvick
 May 19 1992
 9/22/00
 STATE OF OREGON

- 156.5ac PERMITS #G-6893 PRIMARY) & #G-7036 (Supplemental)
- 93.9ac PERMIT #G-6893 (PRIMARY)

WELL 1 LOCATED 960' N.& 30'E. FROM THE S. 1/4 CORNER SECTION 23
 WELL 3 LOCATED 60' S.& 820'E. FROM THE N.W. CORNER SECTION 23

0 1320 2640
 SCALE IN FEET
 9/21/00
 3522.005
 3522LLFP.DWG

NOTE: THE PURPOSE OF THIS MAP IS TO IDENTIFY THE APPROXIMATE LOCATION OF THE WATER RIGHT. IT IS NOT INTENDED TO PROVIDE INFORMATION RELATIVE TO THE LOCATION OF PROPERTY OWNERSHIP BOUNDARY LINES.

RECEIVED

JAN - 2 1998



WATER RESOURCES DEPARTMENT
SALEM, OREGON

L&L FARMS

PROPOSED WATER RIGHTS TRANSFER MAP T-6970

T. 3N. R. 28E.W.M.

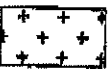
UMATILLA COUNTY

- FROM  PERMITS #G-6893 (PRIMARY) & #G-7036 (Supp)
WATER RIGHTS FROM THESE LOCATIONS
- TO  PERMITS #G-6893 (PRIMARY) & #G-7036 (Supp)
WATER RIGHTS TO THESE LOCATIONS
- FROM  PERMIT #G-6893 (PRIMARY)
WATER RIGHTS FROM THESE LOCATIONS
- TO  PERMIT #G-6893 (PRIMARY)
WATER RIGHTS TO THESE LOCATIONS

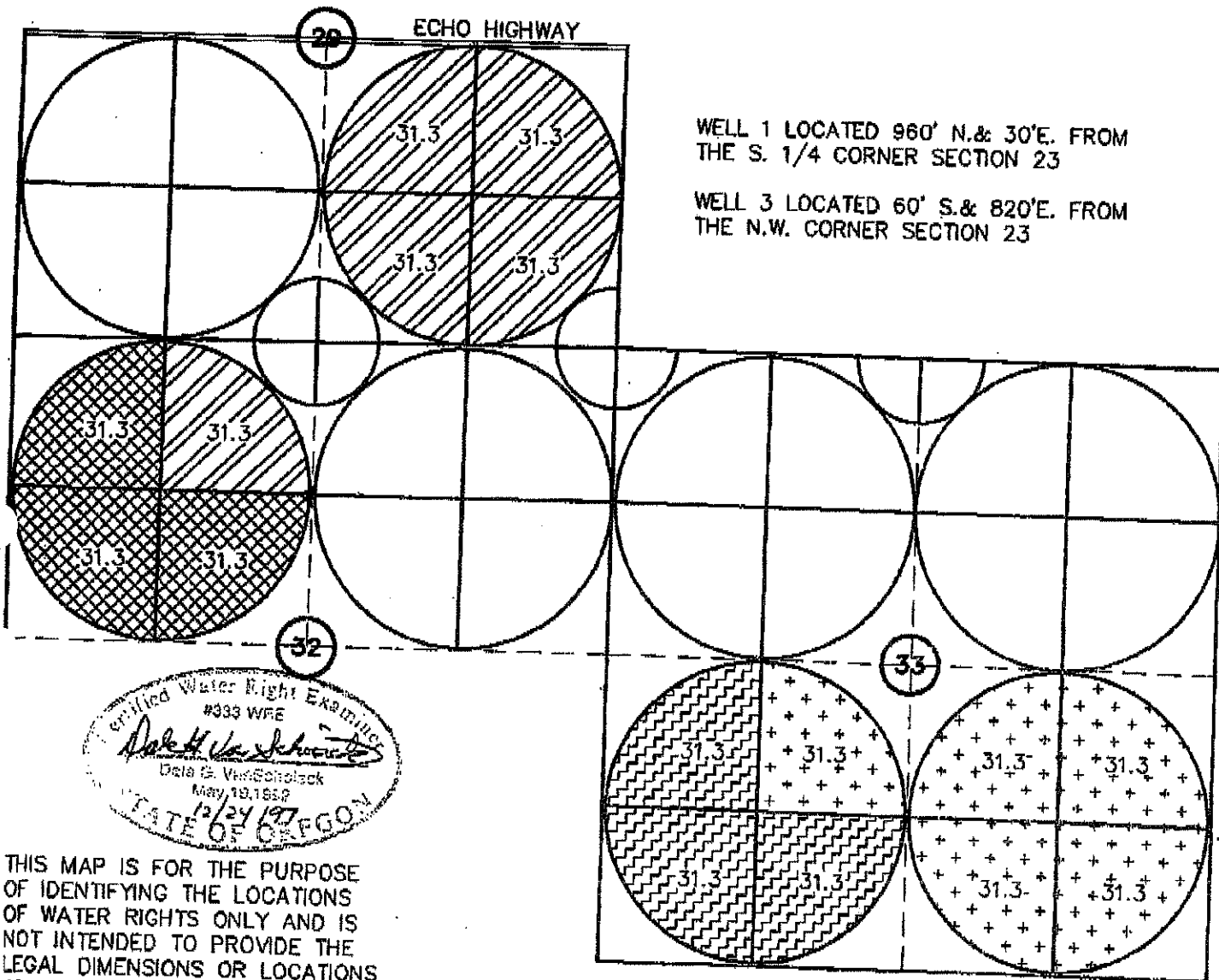

Permitted Water Right Examination
#9393 WRE
Robert Van Schoelack
Dale G. Van Schoelack
May 19, 1997
STATE OF OREGON
12/24/97

THIS MAP IS FOR THE PURPOSE OF IDENTIFYING THE LOCATIONS OF WATER RIGHTS ONLY AND IS NOT INTENDED TO PROVIDE THE LEGAL DIMENSIONS OR LOCATIONS OF PROPERTY OWNERSHIP LINES.

0' 660' 1320' 2640'

SCALE: 1" = 1320'

3522.005

75201 M.S. 0004