

T. 10S. R. 2W. W.M.

AUG 10 2000

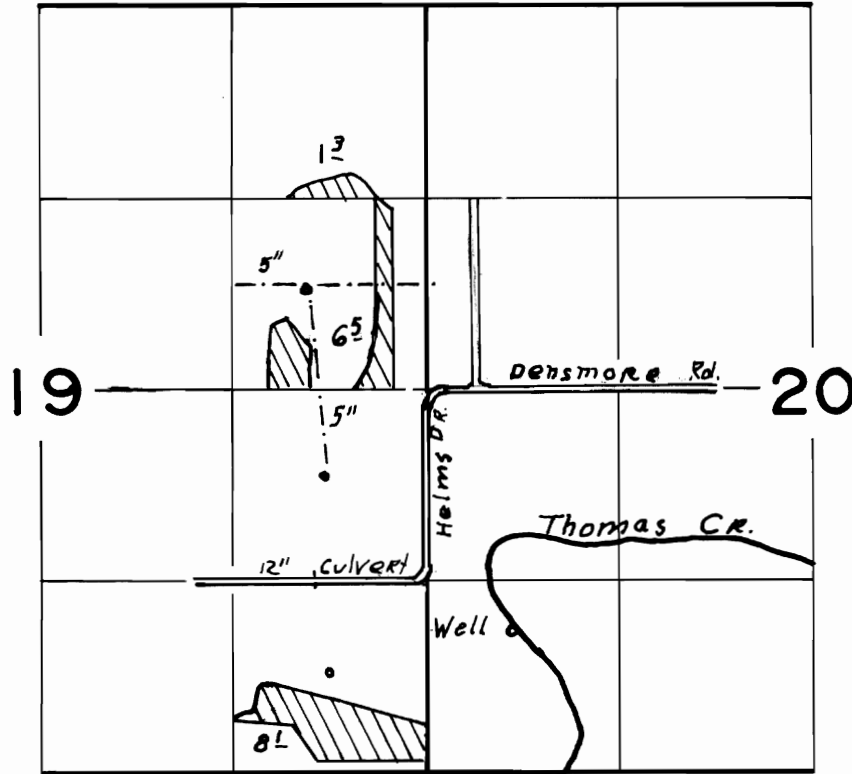

SCALE
4" = 1 MI.

Well "POD" loc. 1650'S & 530' E from W 1/4 Cor. Sec. 20

FINAL PROOF SURVEY UNDER

TRANSFER NO. T-7320

Application No. Permit No.
IN NAME OF

MILLER FORESTS, INC.

Surveyed AUG. 1, 2000, by

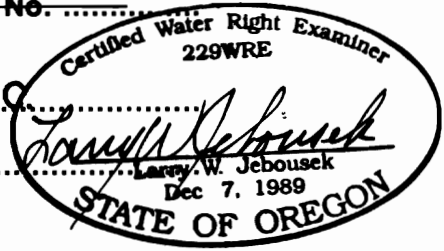

THIS MAP WAS PREPARED FOR THE PURPOSE OF IDENTIFYING THE LOCATION OF A WATER RIGHT ONLY AND IS NOT INTENDED TO PROVIDE LEGAL DIMENSIONS OR LOCATION OF PROPERTY OWNERSHIP LINES.