

KENT & SHANNON MADISON TRANSFER WATER RIGHT PERMIT 51017 UNDER S.B. 516

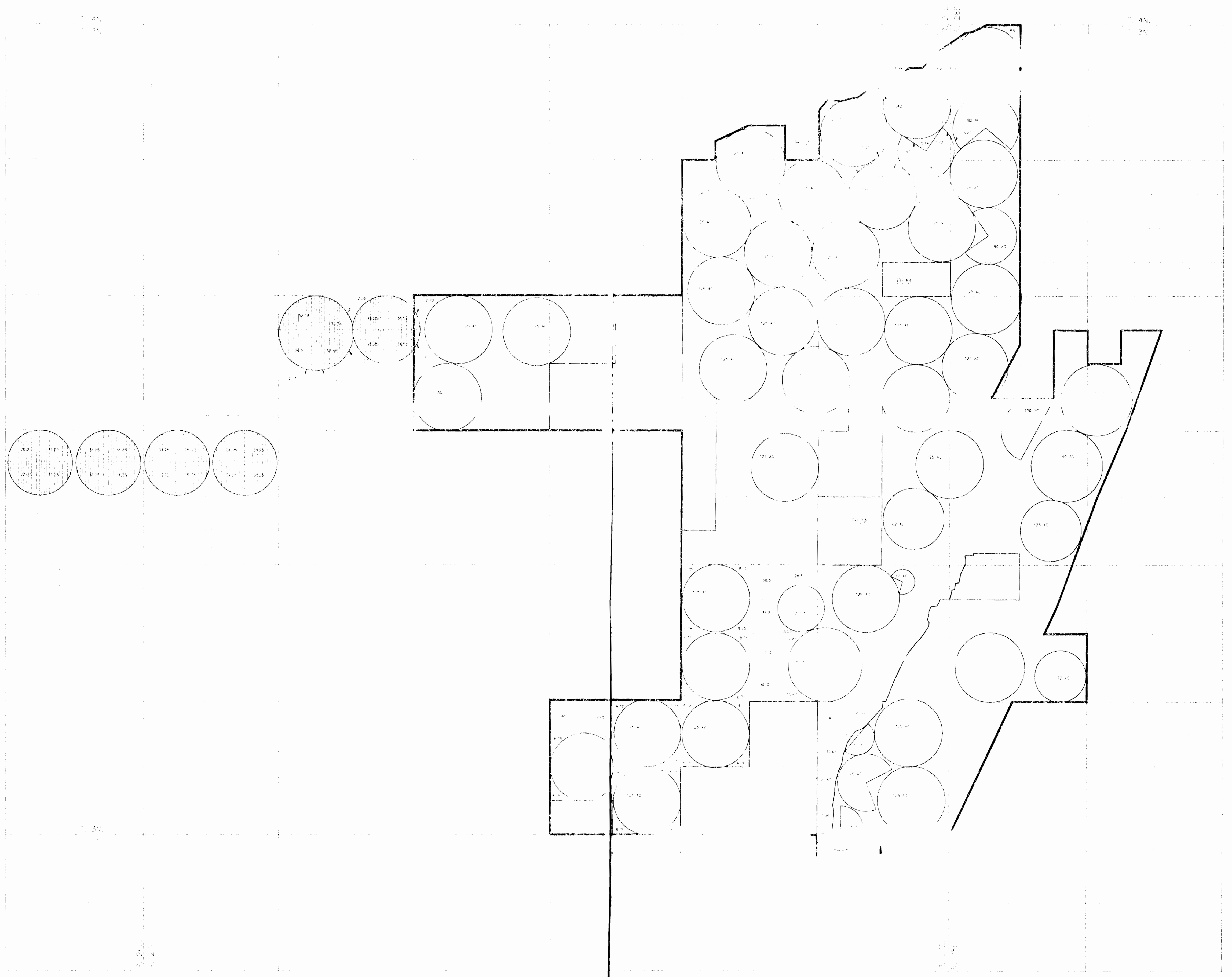

- KENT MADISON TRANSFER BOUNDARY
- LAND OF THE MADISON COMPANY, BUT NOT PART OF THE WATER RIGHT APPLICATION
- LAND WHICH WILL BE DEVELOPED UNDER PERMIT 51017 APPLICATION 10210
- LAND WHICH WILL BE DEVELOPED UNDER PERMIT 51017 APPLICATION 10210

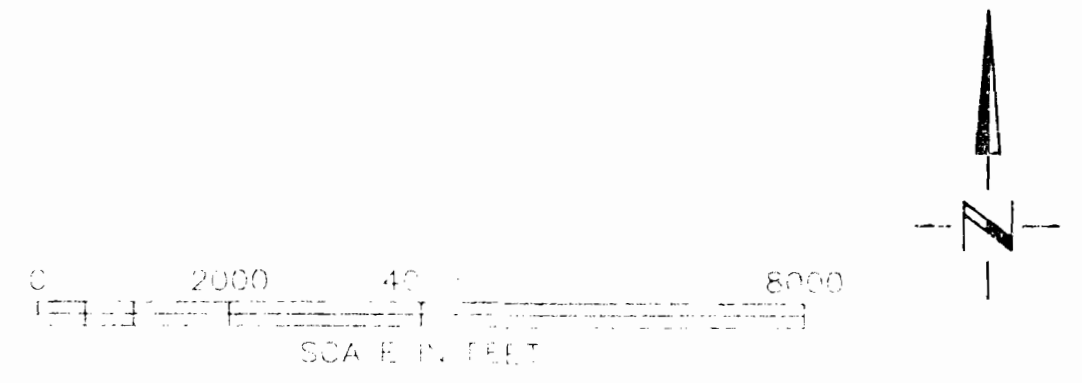

THE PURPOSE OF THIS MAP IS TO IDENTIFY THE APPROXIMATE LOCATION OF THE WATER RIGHT. IT IS NOT INTENDED TO PROVIDE INFORMATION TO THE LOCATION OF PROPERTY OWNERSHIP BOUNDARIES.