

*CLAIM OF BENEFICIAL USE  
AND FINAL PROOF SURVEY MAP*

T - 7330

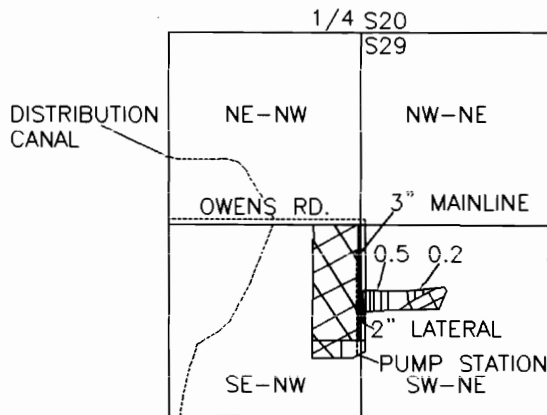

*SECTION 29, T.14S., R.16E.,  
W.M., CROOK COUNTY, OR.*



*PREPARED FOR*

KATHLEEN M. OVERALL  
DAVID C. GRINDSTAFF  
WANDA M. GRINDSTAFF  
6261 S. COPLEY ROAD  
POWELL BUTTE, OR 97753  
(541) 548-7560

*LEGEND*

-  NO WATER RIGHT
-  WATER TRANSFER COMPLETED
-  EXISTING WATER RIGHT - NO CHANGE  
PRIMARY - OCHOCO RES. & CREEK C.55974  
SUPPLEMENTARY - PRINEVILLE RES. - C.57613

**RECEIVED**

**OCT 01 2001**

**WATER RESOURCES DEPT.  
SALEM, OREGON**

THE PREPARATION OF THIS MAP IS FOR THE PURPOSE OF IDENTIFYING THE LOCATION OF THE WATER RIGHT ONLY AND HAS NO INTENT TO PROVIDE DIMENSIONS OR LOCATIONS OF PROPERTY OWNERSHIP LINES.

NO CHANGE IN POINTS OF DIVERSION IN TRANSFER

*ARMSTRONG SURVEYING  
& ENGINEERING, INC.  
378 NE SECOND ST.  
PRINEVILLE, OR 97754  
(541) 447-7791*

*SEPTEMBER 25, 2001*

*BY: D.B.A.*

*W.O. 01-2162*

*SCALE: 1" = 1320'*

*David B. Armstrong*  
9/26/01  
Renews 12/31/01