

T.4S. R.3W. Sec. 30 T.4S. R.4W. Sec. 25 and 36

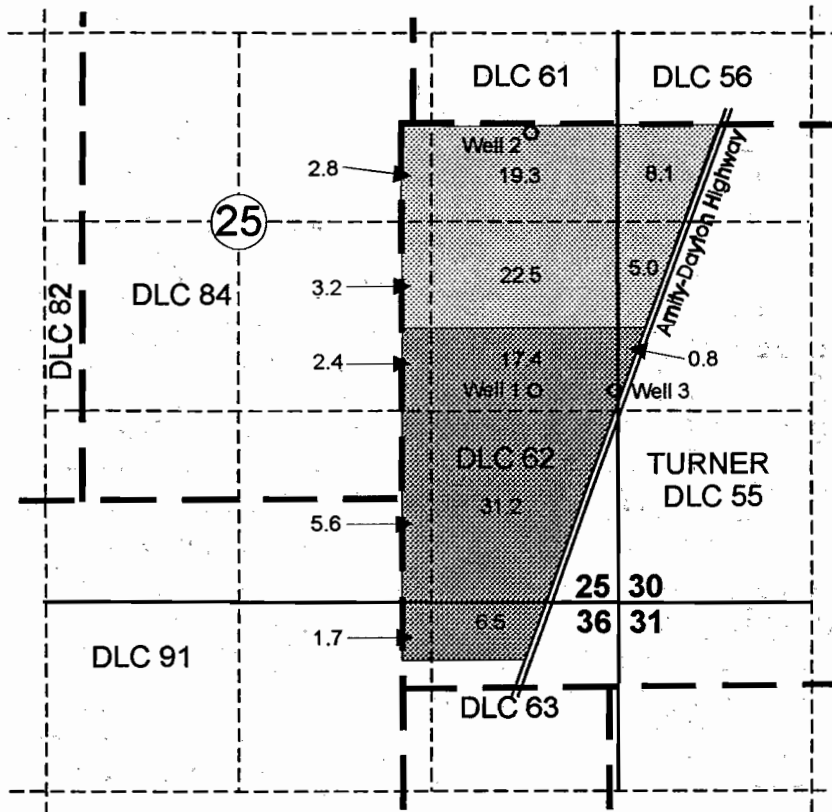

Well 1 is located 1,450 feet north and 580 feet west of the southeast corner of Section 25.

Well 2 (YAMH 5853) is located 3,250 feet north and 600 feet west of the southeast corner of Section 25.

Proposed Well 3 is located 1,450 feet north and 25 feet west of the southeast corner of Section 25.

Area irrigated by Well 1, with Wells 2 and 3 added as additional points of appropriation.

Area irrigated by Well 2, with Wells 1 and 3 added as additional points of appropriation.

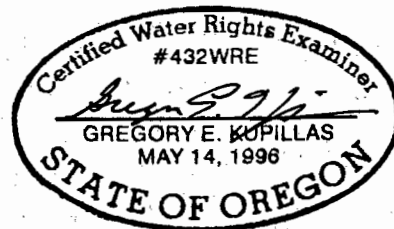
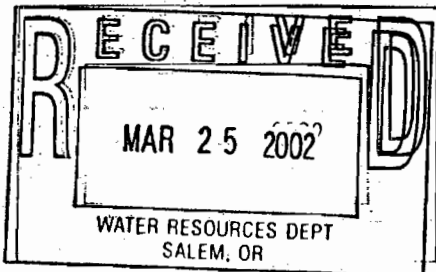

EXPIRATION DATE 6/30/03

Scale: 1" = 1,320'

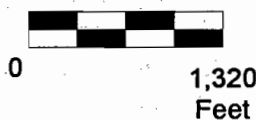

This map was prepared for the purpose of identifying the location of a water right only and is not intended to provide legal dimensions or location of property ownership lines.



Water Right Transfer Application Map

R & B Kauer Properties LLC
T.4S. R.3W. Sec. 30 and
T.4S. R.4W. Sec. 25 and 36

Pacific Hydro-Geology Inc.

T-9067