

T.6S., R.2W., W.M.

NOV 19 1937

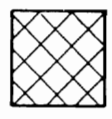
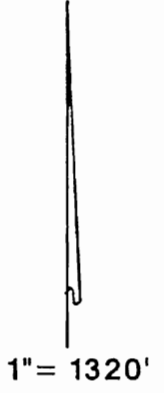
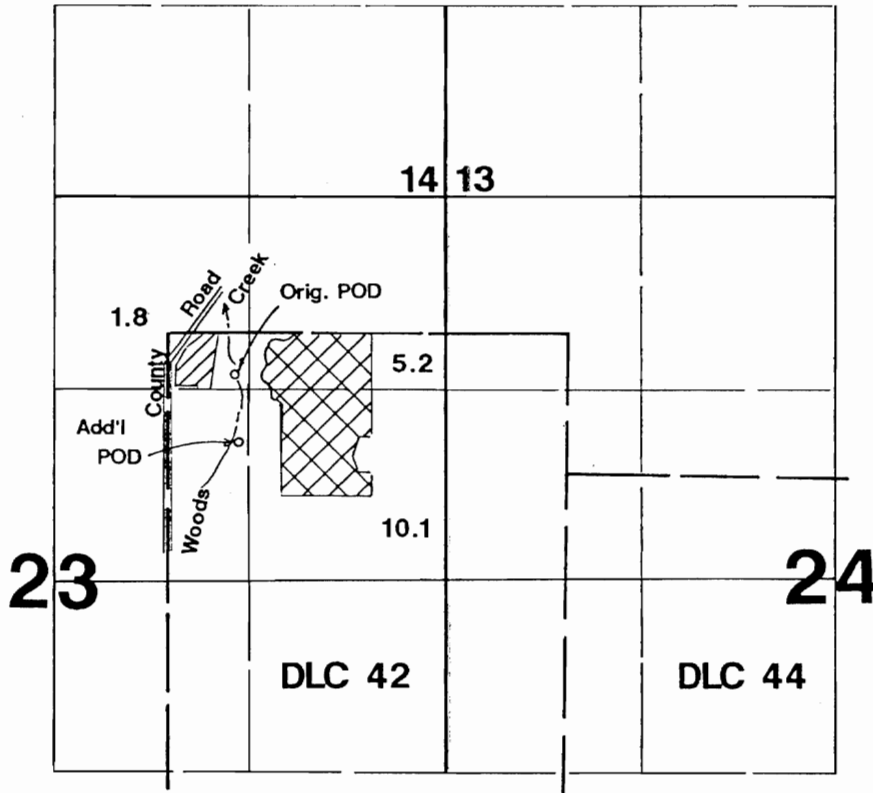

Area Transferred to Add'l POD

Well located 710'S & 470'E from NW corner DLC 42.

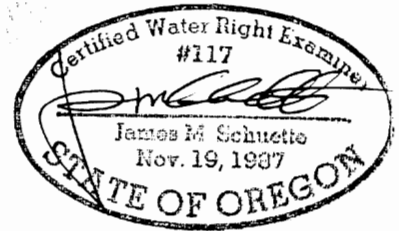

Application Map

Eugene S. Shreyer

T-7447

Transfer #:

THIS MAP WAS PREPARED FOR THE PURPOSE OF IDENTIFYING THE LOCATION OF A WATER RIGHT ONLY AND IS NOT INTENDED TO PROVIDE LEGAL DIMENSIONS OR LOCATION OF PROPERTY OWNERSHIP LINES.