

T-8147

# WESTLAND IRRIGATION DISTRICT TEMPORARY TRANSFER MAP FOR DOUBLE M RANCH INC

TOWNSHIP 3 NORTH RANGE 28 E WM

PERMIT 25920

PERMIT 25924

**RECEIVED**

DEC 28 1998

WATER RESOURCES DEPT.  
SALEM, OREGON

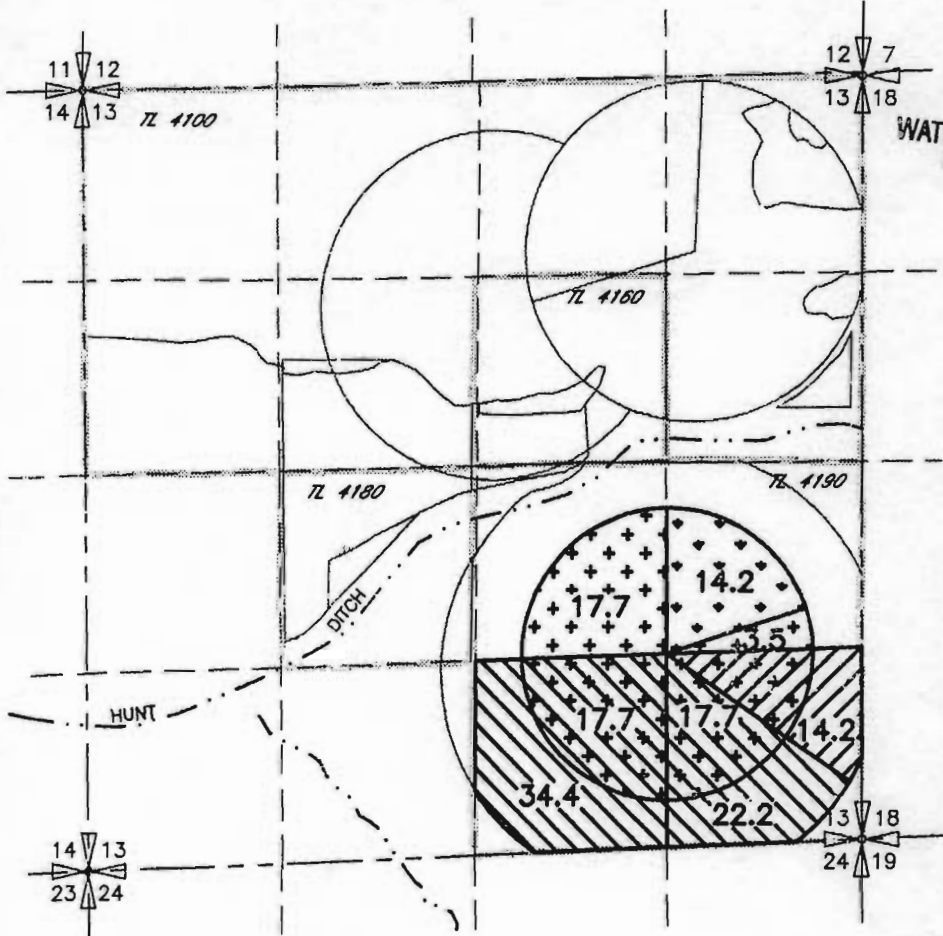

FROM		TO
	PERMIT 25920	
	PERMIT 25924	

T3N R29E WM

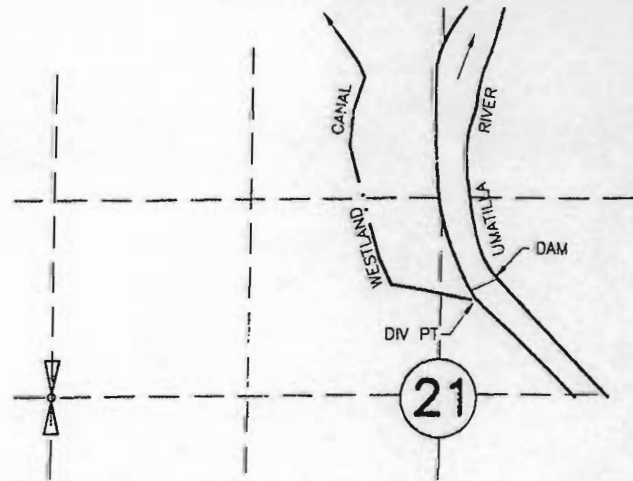
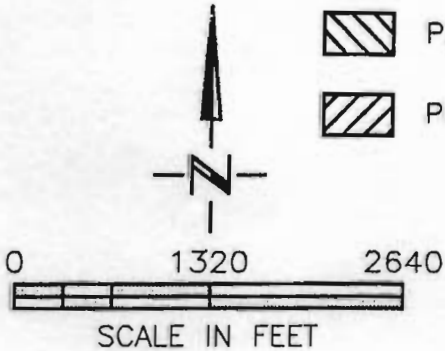

P.O.D.  
LOCATED NORTH 76°45'56" EAST, 2913.19' FROM W.1/4 COR. SEC 21

NOTE:  
THE PURPOSE OF THIS MAP IS TO IDENTIFY THE APPROXIMATE LOCATION OF THE WATER RIGHT. IT IS NOT INTENDED TO PROVIDE INFORMATION RELATIVE TO THE LOCATION OF PROPERTY OWNERSHIP BOUNDARY LINES.