

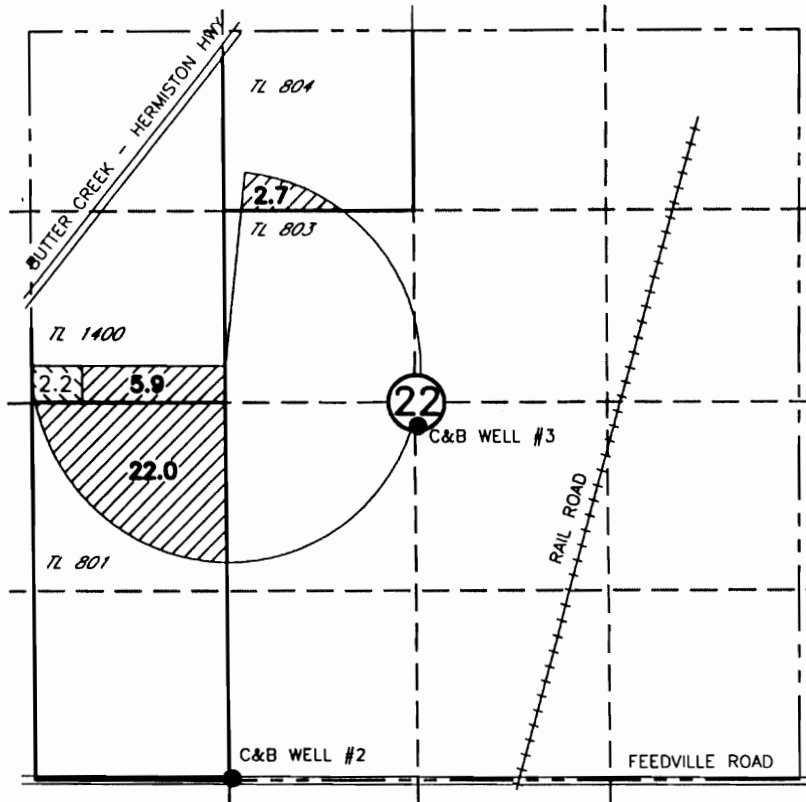

FINAL PROOF MAP
 FOR TRANSFER T-7532, PERMIT G-3034
 HWC, INC
 T4N, R28E WM

RECEIVED
 OCT 01 2002
 WATER RESOURCES DEPT
 SALEM, OREGON



POINT OF APPROPRIATION
 C&B WELL #2 LOCATED
 10' N AND 1330' E FROM THE SW CORNER SEC 22

- WELL
-  **30.6 AC** AREA OF PRIMARY IRRIGATION UNDER T-7532
-  **2.2 AC** AREA OF SUPPLEMENTAL IRRIGATION

Certified Water Right Examiner
 #333 WRE
Dale G. Van Schoiack
 Dale G. Van Schoiack
 May 19, 1992
 7/30/02
 STATE OF OREGON

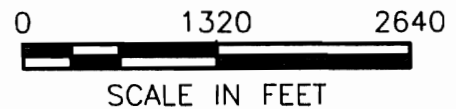

NOTE:
 THE PURPOSE OF THIS MAP IS TO IDENTIFY THE APPROXIMATE LOCATION OF THE WATER RIGHT. IT IS NOT INTENDED TO PROVIDE INFORMATION RELATIVE TO THE LOCATION OF PROPERTY OWNERSHIP BOUNDARY LINES.