

L&L FARMS
T. 3N. & 2N, R. 28E.W.M.
1999 SEASON
TEMPORARY TRANSFER MAP 1 of 2

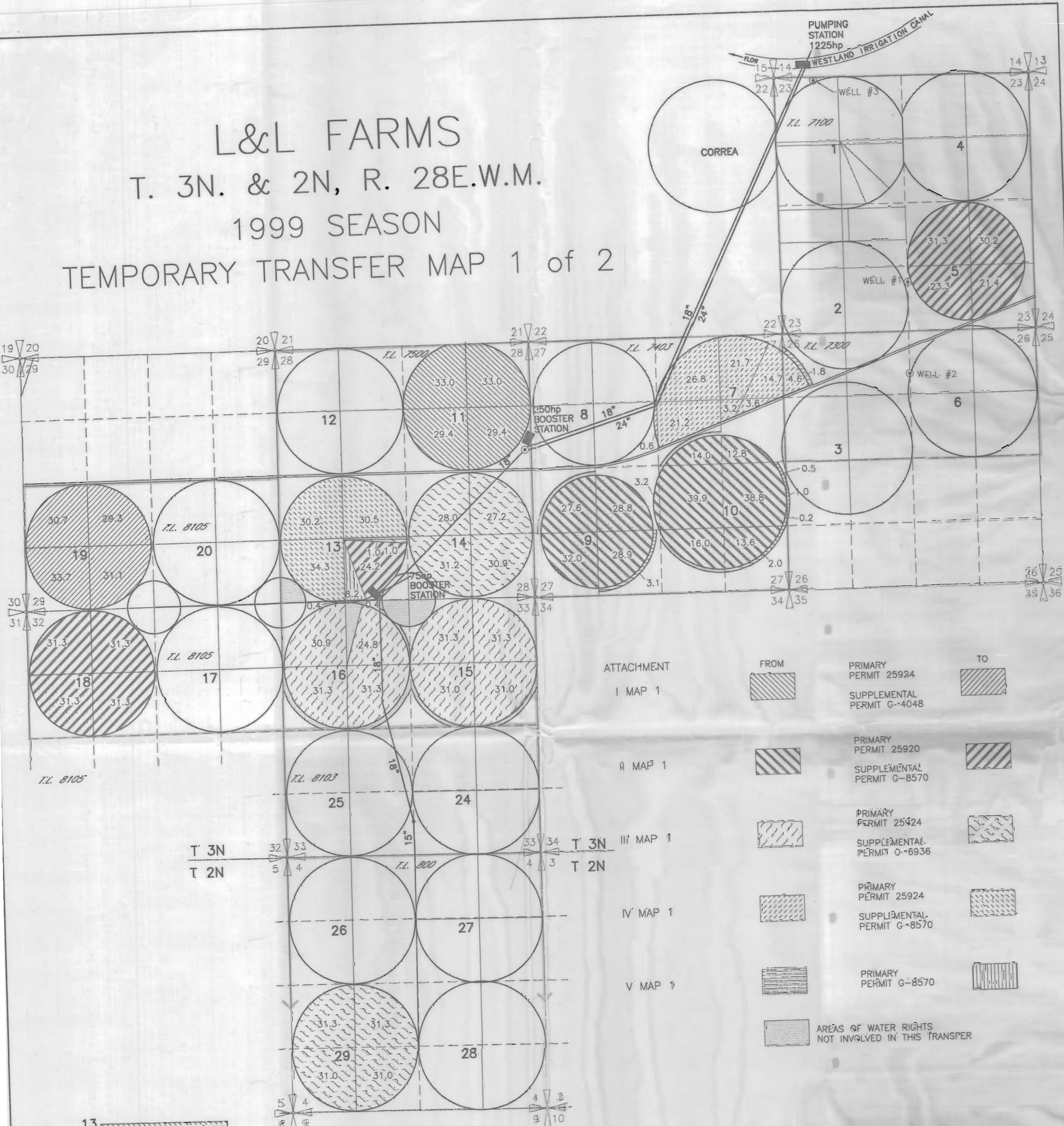

ATTACHMENT	FROM	TO
I MAP 1	PRIMARY PERMIT 25924	SUPPLEMENTAL PERMIT G-4048
II MAP 1	PRIMARY PERMIT 25920	SUPPLEMENTAL PERMIT G-8570
III MAP 1	PRIMARY PERMIT 25424	SUPPLEMENTAL PERMIT G-6936
IV MAP 1	PRIMARY PERMIT 25924	SUPPLEMENTAL PERMIT G-8570
V MAP 1	PRIMARY PERMIT G-8570	

AREAS OF WATER RIGHTS NOT INVOLVED IN THIS TRANSFER

T.3N., R.29E., W.M.
DIV PT LCT N.76°45'56"E. 2913.19' FROM W.1/4 COR. SEC 21

WELL 1 LOCATED 960' N. & 30'E. FROM THE S. 1/4 CORNER SECTION 23
WELL 2 LOCATED 930' S. FROM THE N. 1/4 CORNER SECTION 26
WELL 3 LOCATED 60' S. & 820'E. FROM THE N.W. CORNER SECTION 23

L&L FARMS
T. 3N. & 2N, R. 28E.W.M.
1999 SEASON
TEMPORARY TRANSFER MAP 2 of 2

RECEIVED
DEC 28 1998
WATER RESOURCES DEPT.
SALEM, OREGON

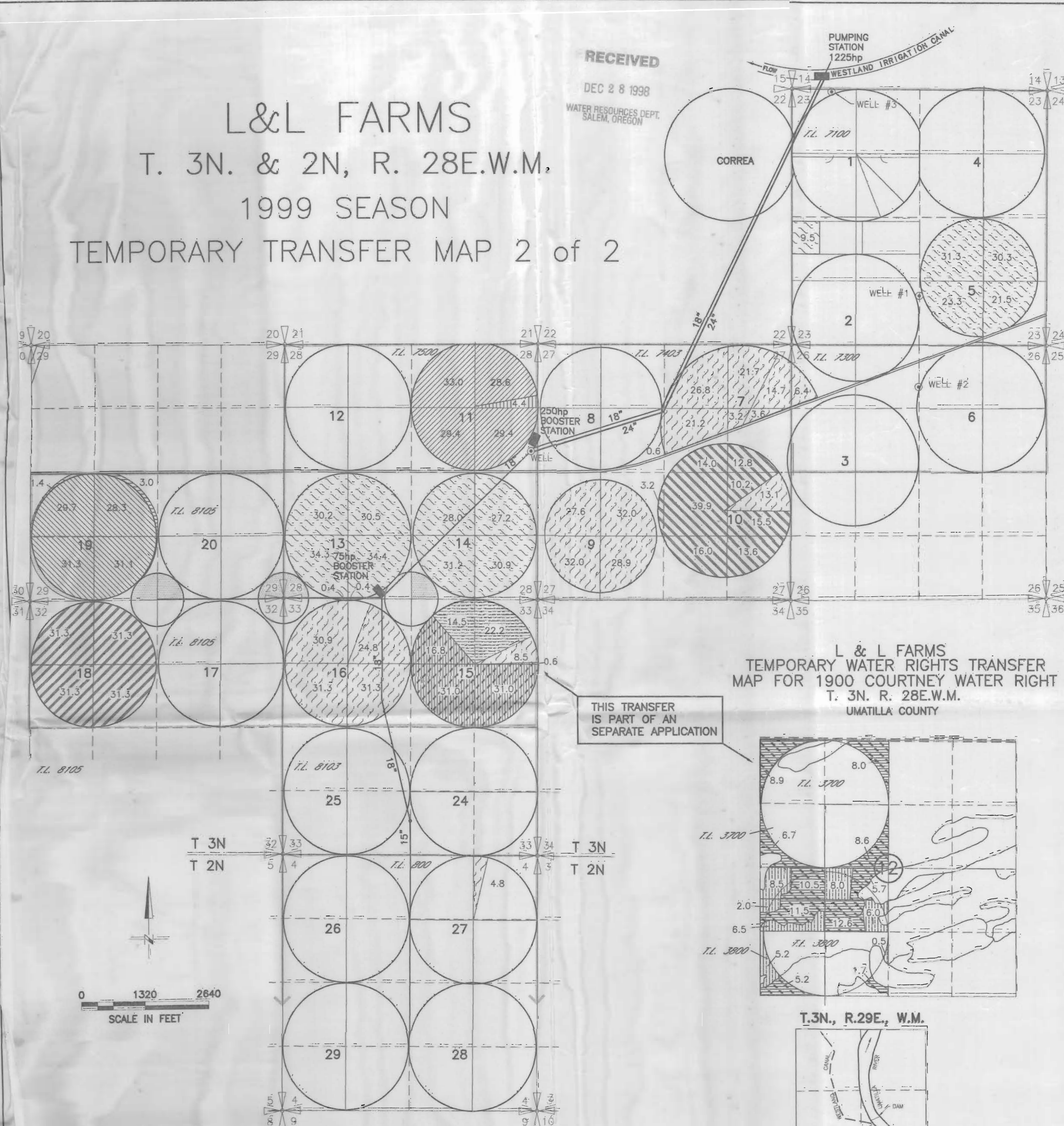

ATTACHMENT	FROM	TO
I MAP2	PRIMARY PERMIT 25924	SUPPLEMENTAL PERMIT G-6893 PERMIT G-7036
II MAP2	PRIMARY PERMIT G-6893	SUPPLEMENTAL PERMIT G-7036
III MAP2	PRIMARY PERMIT 48968	
IV MAP2	PRIMARY PERMIT 25924	
MAP2	PRIMARY 1900 JAN 9 COURTNEY	
MAP2	PRIMARY 1900 COURTNEY	

AREAS OF WATER RIGHTS NOT INVOLVED IN THIS TRANSFER

L & L FARMS
TEMPORARY WATER RIGHTS TRANSFER
MAP FOR 1900 COURTNEY WATER RIGHT
T. 3N. R. 28E.W.M.
UMATILLA COUNTY

THIS TRANSFER IS PART OF AN SEPARATE APPLICATION

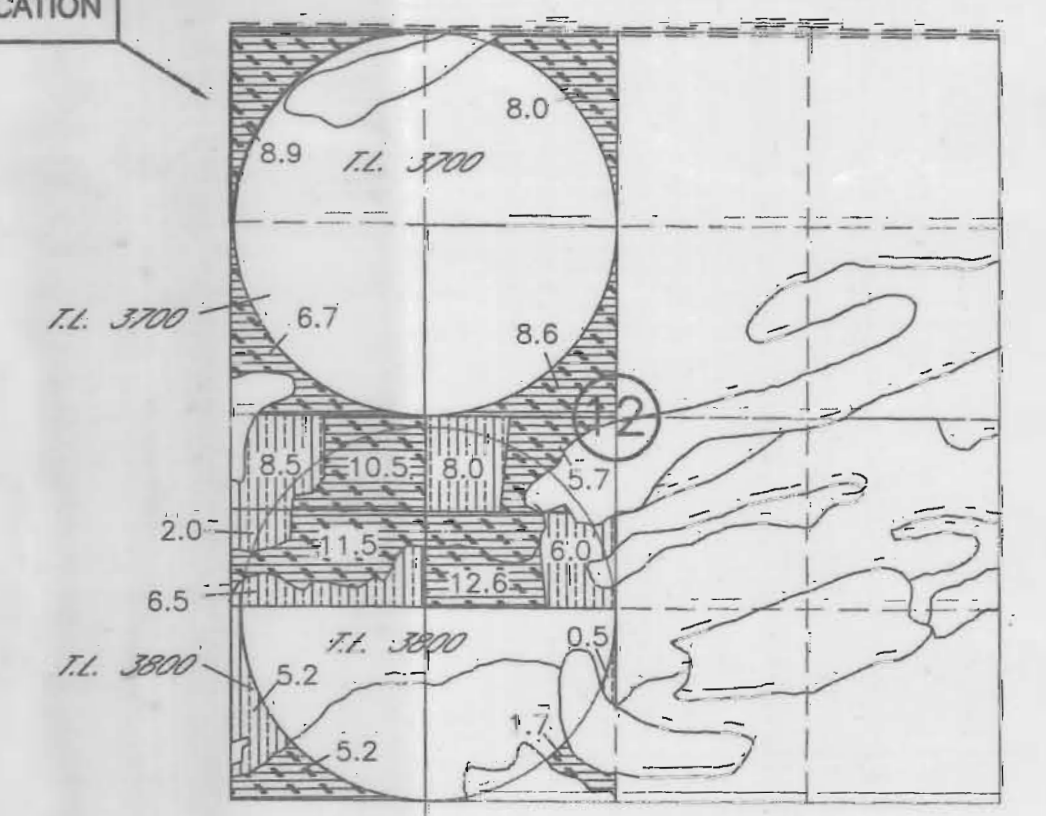

T.3N., R.29E., W.M.

DIV PT LCT S.55°48'E. 3237.3' FROM NE COR. SEC 21 PERMIT 48968

T-8142
T-8143