

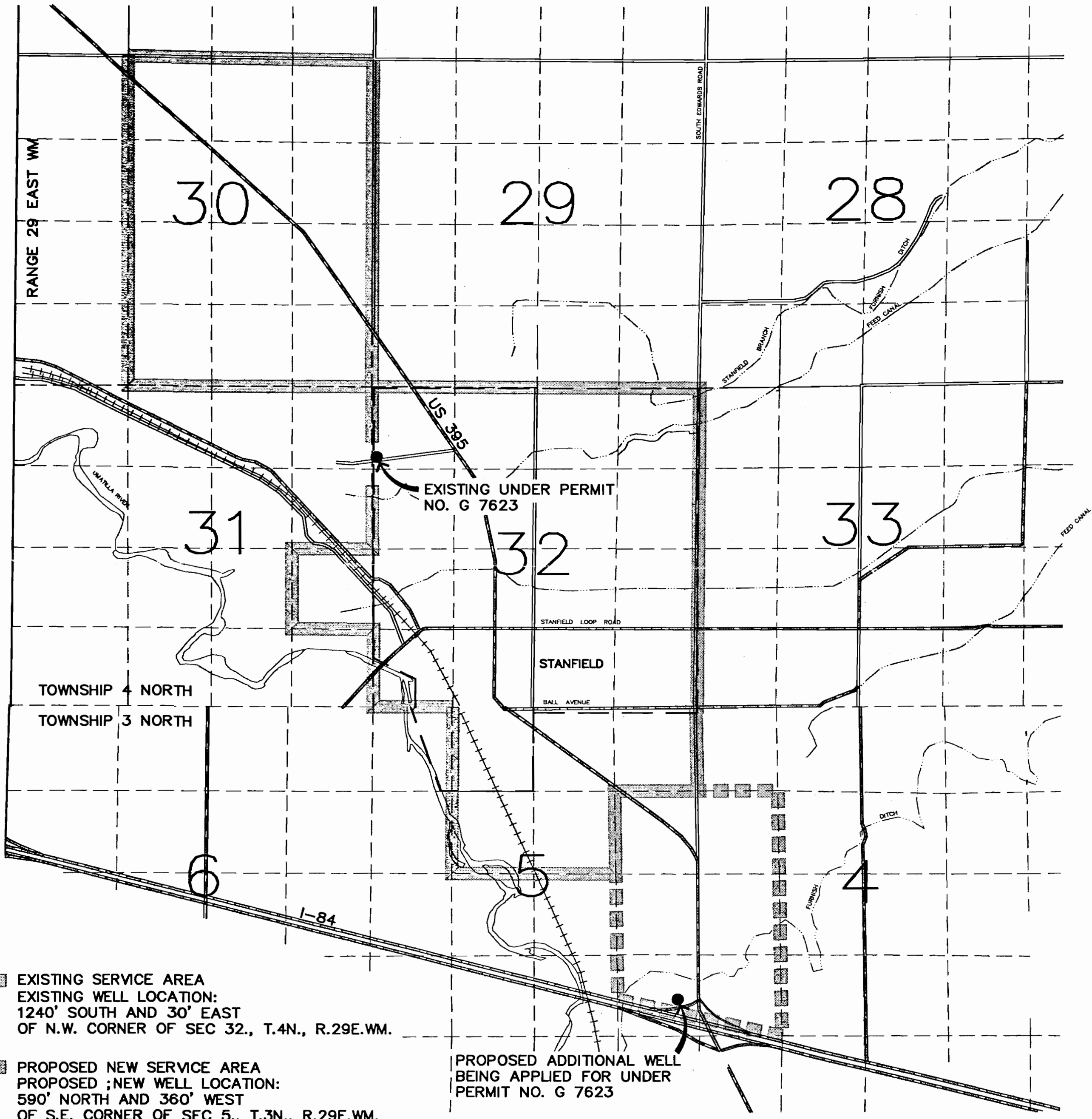

CITY of STANFIELD
 MAP of ADDITIONAL
 POINT of APPROPRIATION and
 ADDITIONAL SERVICE AREA
 UNDER SENATE BILL 516

RECEIVED
 OCT 19 1995
 WATER RESOURCES DEPT.
 SALSMA DRETT



-  EXISTING SERVICE AREA
 EXISTING WELL LOCATION:
 1240' SOUTH AND 30' EAST
 OF N.W. CORNER OF SEC 32., T.4N., R.29E.WM.
-  PROPOSED NEW SERVICE AREA
 PROPOSED ;NEW WELL LOCATION:
 590' NORTH AND 360' WEST
 OF S.E. CORNER OF SEC 5., T.3N., R.29E.WM.

PROPOSED ADDITIONAL WELL
 BEING APPLIED FOR UNDER
 PERMIT NO. G 7623

