

T.6S. R.1W. Section 24, W.M.

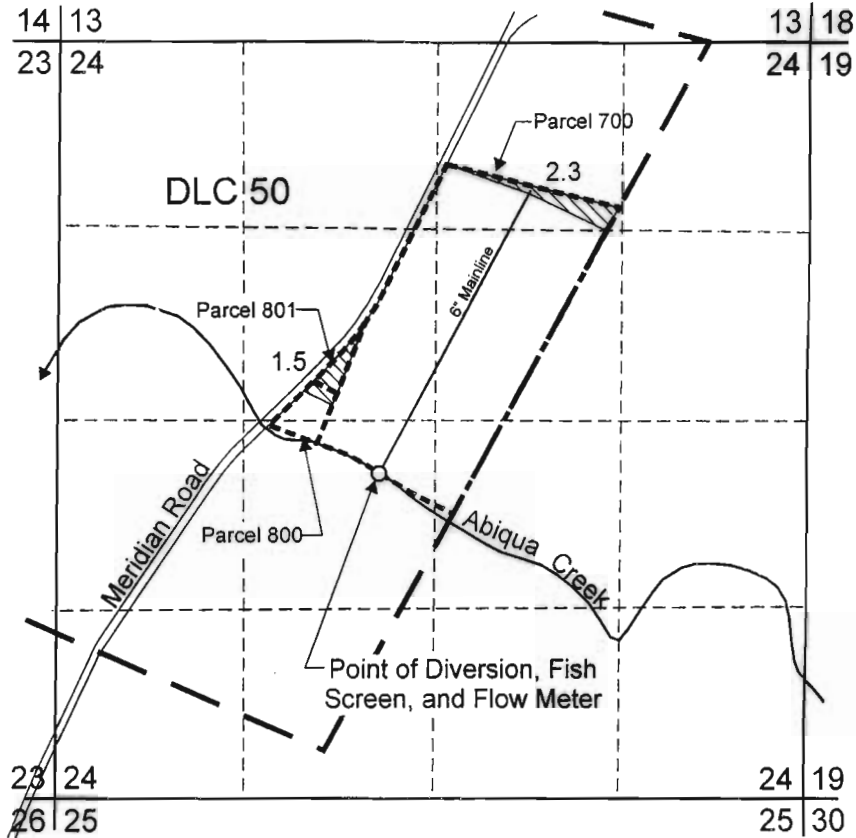

Point of Diversion is located 2,980 feet south and 3,030 feet west from the NE corner, Section 24.

 Area (3.8 Acres) irrigated under Transfer 8196.

 Tax lot boundary

RECEIVED
 DEC 20 2007
 WATER RESOURCES DEPT
 SALEM, OREGON

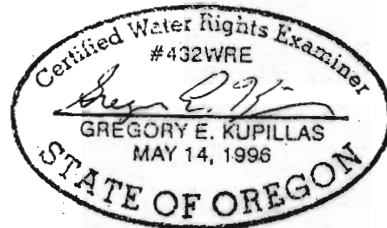

EXPIRATION DATE: 6/30/09

Scale: 1" = 1,320'



This map was prepared for the purpose of identifying the location of a water right only and is not intended to provide legal dimensions or location of property ownership lines.

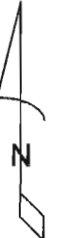

Pacific Hydro-Geology Inc.

12/2007

Claim of Beneficial Use Map
Transfer 8196
 Paul Kraemer
 Tax Map 6 1W 24, Parcels 700, 800, and 801