

TOWNSHIP 9 SOUTH, RANGE 4 WEST, WM

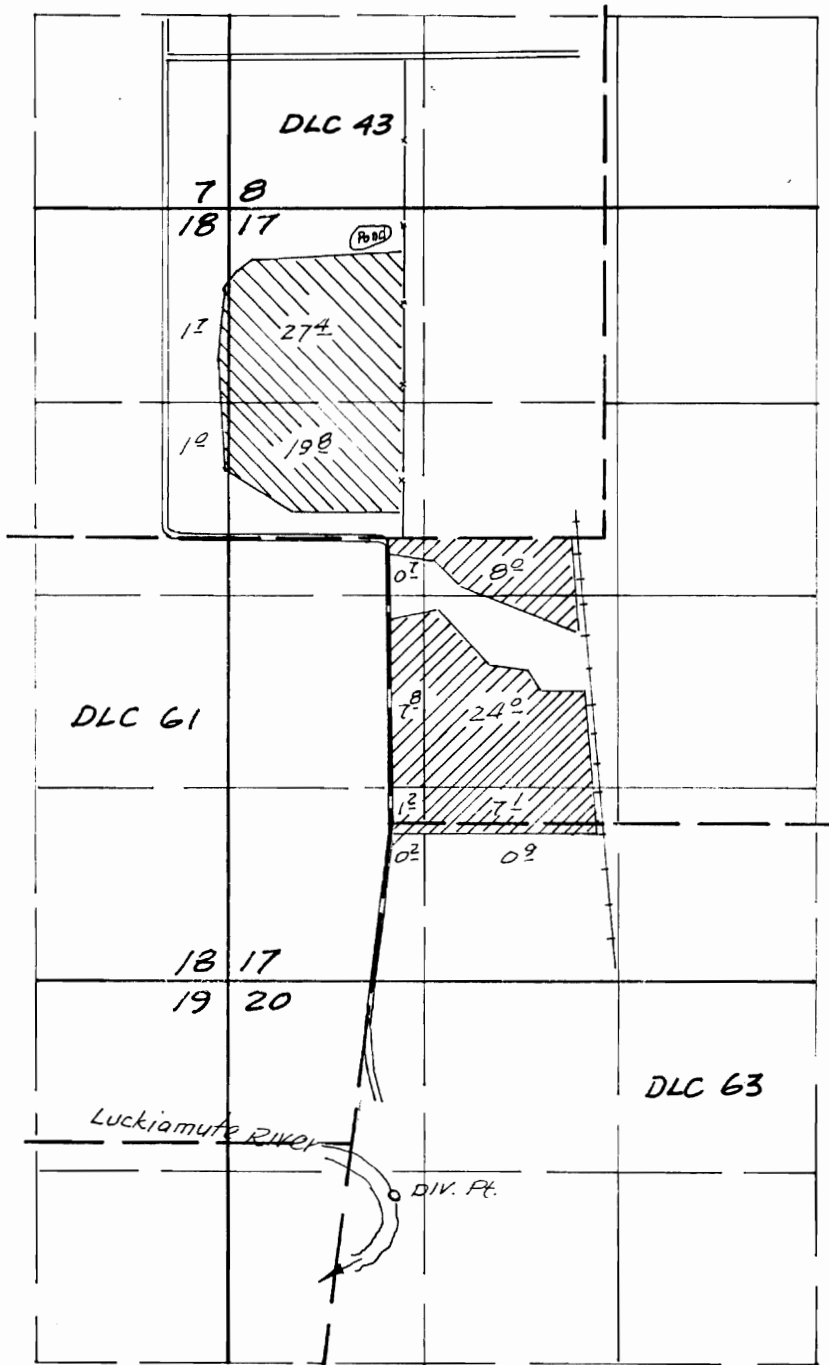

RECEIVED

JUN 14 1996

 Transfer to:
 Transfer from:

Diversion Point Located: 2530 ft. S. & 30 ft. E from NW cor. DLC 63

**Temporary Transfer for Sperling Farms
Phillip, Delia, Wendell & Sherry Sperling**

Map prepared June 6, 1996, by Ves Garner, Water Resources Consultant

T-7578