

T.34S.,R.1E.,W.M. RECEIVED

SEP 28 1999

WATER RESOURCES DEPT
SALEM, OREGON



SCALE 1" = 400'

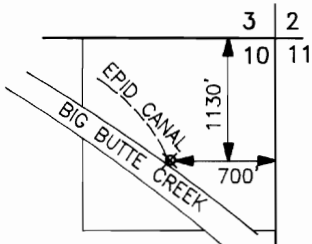

E.P.I.D. POINT OF DIVERSION

T.35S.,R.2E.,W.M.

SCALE 1" = 1320'

26 1/4 COR. BRASS CAP

35

NE1/4 NW1/4

NW1/4 NE1/4

NOTE: MAP PREPARED FOR
WATER RIGHT PURPOSES ONLY,
NOT FOR PROPERTY BOUNDARY
LOCATIONS.

G.O.K.

RES. SPILLWAY WITH 8" PVC CONDUIT PIPE

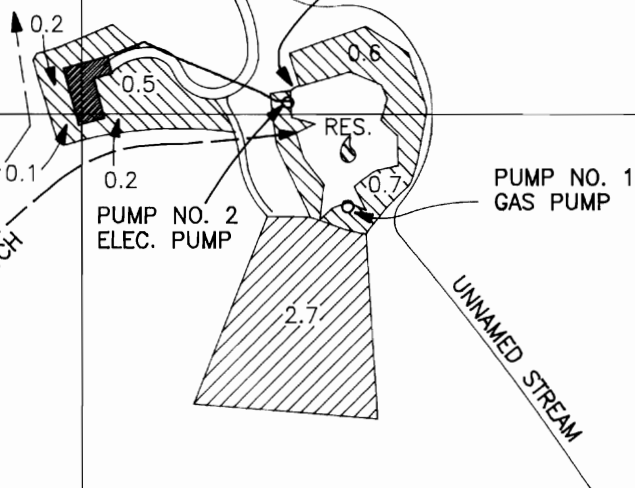

SE1/4 NW1/4

SW1/4 NE1/4

FINAL PROOF MAP

APPLICATION No. T-7585

IN THE NAME OF
MICHAEL AND RITA WARREN



= AREA IRRIGATED WITH GAS POWERED PUMP



= AREA IRRIGATED WITH ELEC. POWERED PUMP