

W1/2 SW1/4 Section 14, T.36 S.,R.6 W.,W.M.

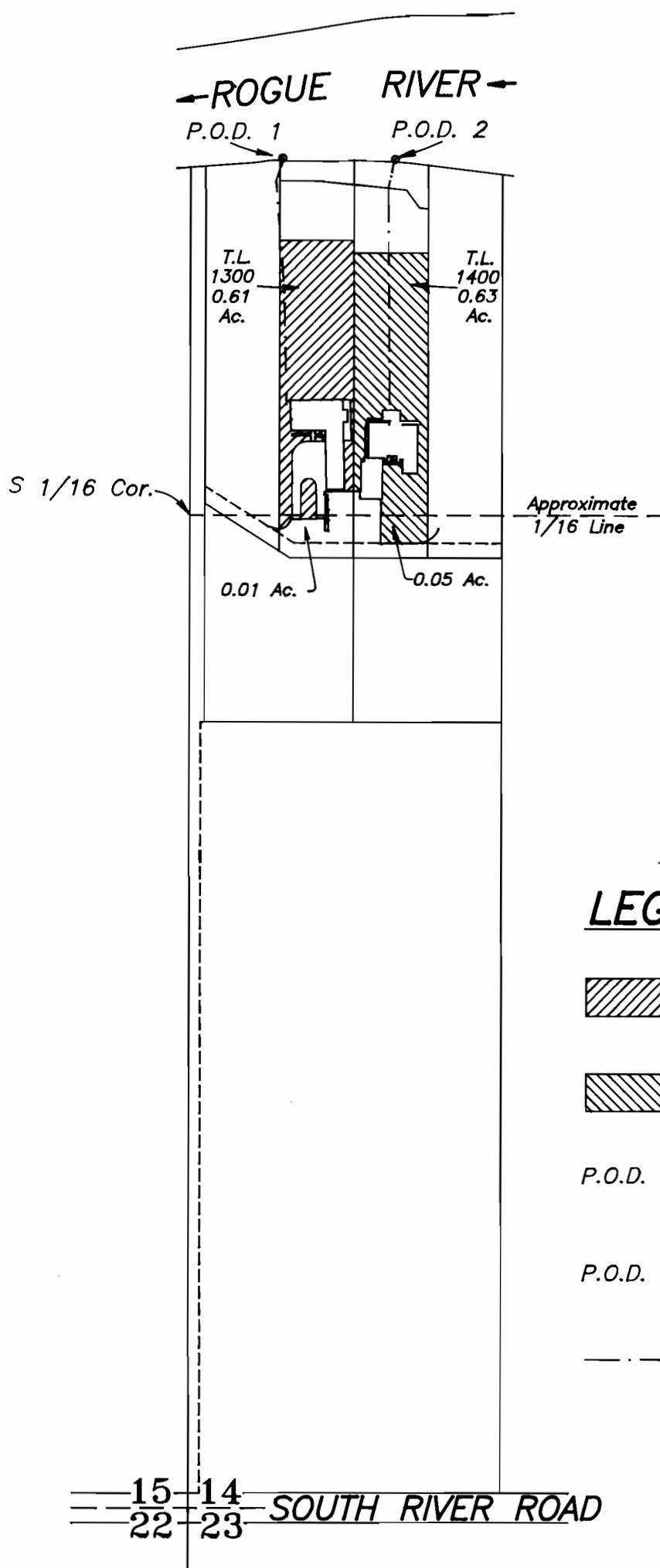

SCALE:
1" = 200'

REGISTERED
SALEM, OREGON

LEGEND:



Place of use for J.A. Moore Authorized by Permit No. 52313 (0.62 Acres)
Tax Lot 1300, Map No. 36-6-14



Place of use for Richard Miller Authorized by Permit No. 52393 (0.68 Acres)
Tax Lot 1400, Map No. 36-6-14

P.O.D. 1 Point of diversion for J.A. Moore (1810' North and 124' East of SW corner of Sec. 14)
Authorized by Transfer Order No. T-7609

P.O.D. 2 Point of diversion for Richard Miller (1808' North and 276' East of SW corner of Sec. 14)

— — — 1 1/2" PVC Under Ground Pipe (Approximate Location)

This plat was prepared for the purpose of identifying the location of the water rights only. There is no intent to provide dimensions or locations of property ownership lines.

PROJECT NO.
426-95-307

DRAWING NO.
46-11.17

DATE
12-9-97

Rev 9-13-00

SCALE
1" = 200'

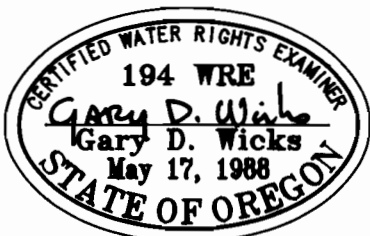

PLAT OF CLAIM OF BENEFICIAL USE

LOCATED IN

W1/2 SW1/4 Section 14, T.36 S.,R.6 W.,W.M.
Josephine County, Oregon

PREPARED FOR:

J.A. Moore	Richard Miller
2992 S. River Rd.	2994 S. River Rd.
Grants Pass, OR 97527	Grants Pass, OR 97527
Tel. (541) 474-3364	Tel. (541) 476-4319

PREPARED BY:

WICKS ENGINEERING & SURVEYING
311 N.E. "D" Street
Grants Pass, Oregon 97526
Tel. (541) 479-3436