

# T.7S. R.1W., W.M.

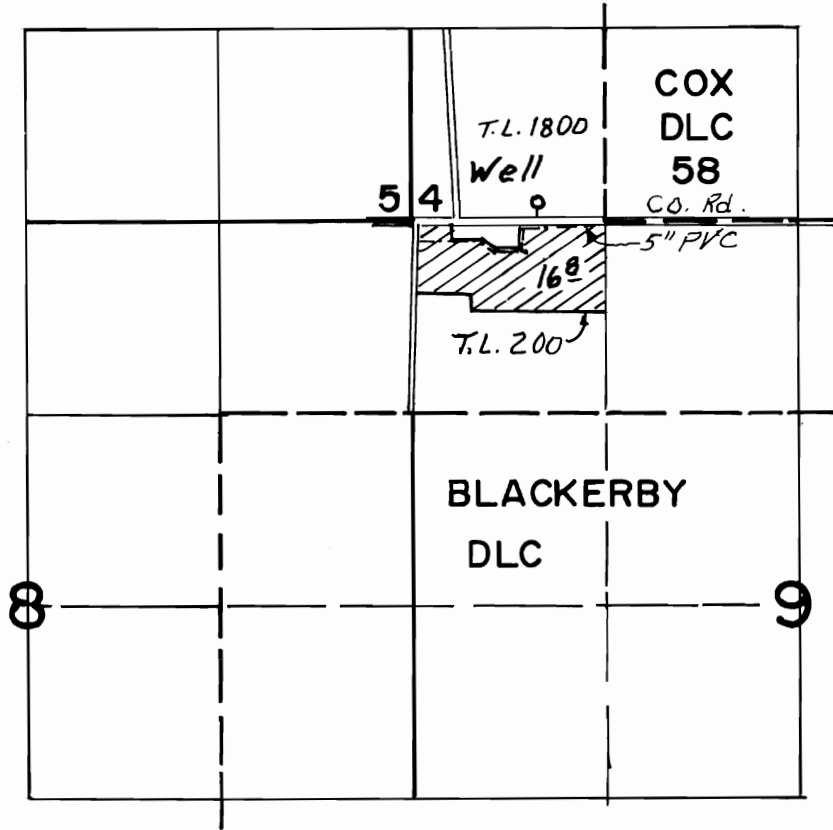

WELL LOC. 130' N & 465' W FROM SW COR DLC 58

## FINAL PROOF SURVEY UNDER

**RECEIVED**

SEP 07 2000

WATER RESOURCES DEPT  
SA. FM. OREGON

TRANSFER NO. T-7658

Application No. .... Permit No. ....

IN NAME OF

**HARRY & DELORIS KLOPFENSTEIN**

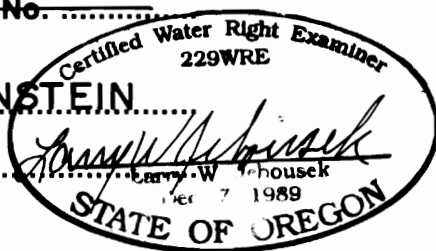

Surveyed **AUG. 5, 2000**, by .....

THIS MAP WAS PREPARED FOR THE PURPOSE OF IDENTIFYING THE LOCATION OF A WATER RIGHT ONLY AND IS NOT INTENDED TO PROVIDE LEGAL DIMENSIONS OR LOCATION OF PROPERTY OWNERSHIP LINES.