

NOV - 5 1996

RECEIVED

WATER RESOURCES DEPT.
SALEM, OREGON

JUN 14 1999

WATER RESOURCES DEPT.
SALEM, OREGON

THE PURPOSE OF THIS MAP IS FOR IDENTIFYING THE LOCATION OF THE WATER RIGHT ONLY AND IS NOT INTENDED TO PROVIDE LEGAL DIMENSIONS OF PROPERTY OWNERSHIP LINES.

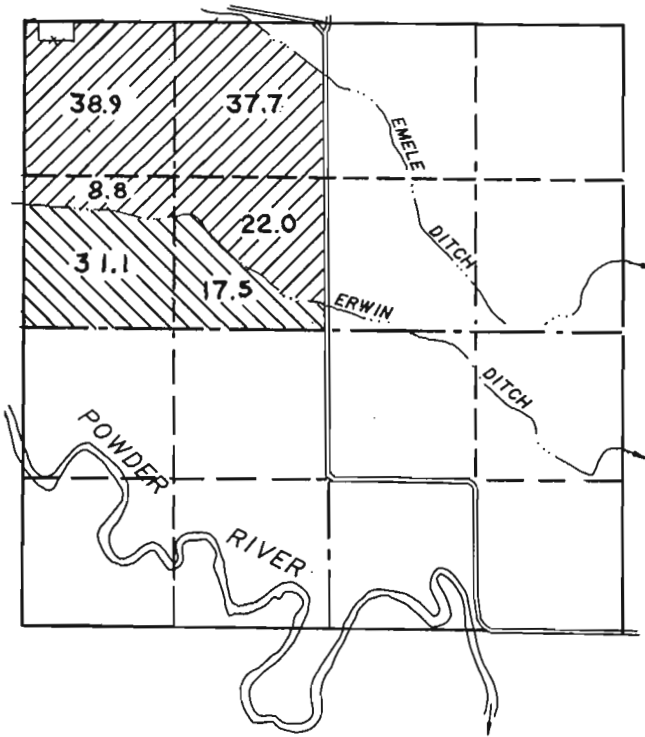

T. 7 S., R. 41 E.

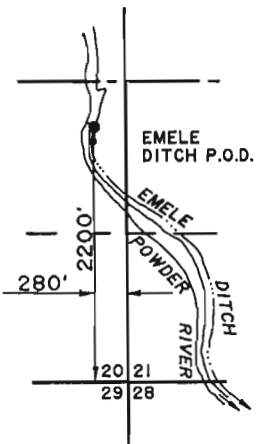

T. 6 S., R. 40 E.



T. 7 S., R. 41 E.

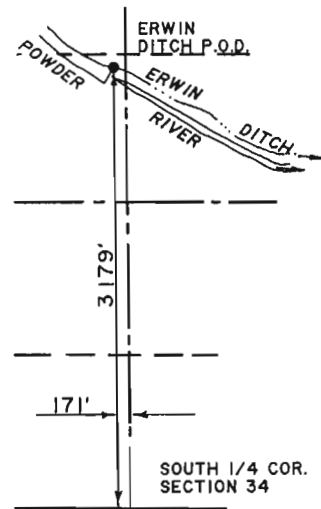

FINAL PROOF SURVEY

Application No. 69536 Permit No. 51031

IN NAME OF

LOWER POWDER RIVER IRRIGATION DISTRICT

Surveyed AUGUST 13, 1992

