

EXISTING OLD BARN

EXISTING POINT OF DIVERSION  
NORTH 2028' AND WEST 1311'  
FROM SE COR SEC 1

S33°55'03"E 2407.37'  
TROUT CREEK

T.10 S. R. 16 E  
T.10 S. R. 17 E

T.10 S. R. 16 E  
T.10 S. R. 17 E



SCALE 1" = 1000'

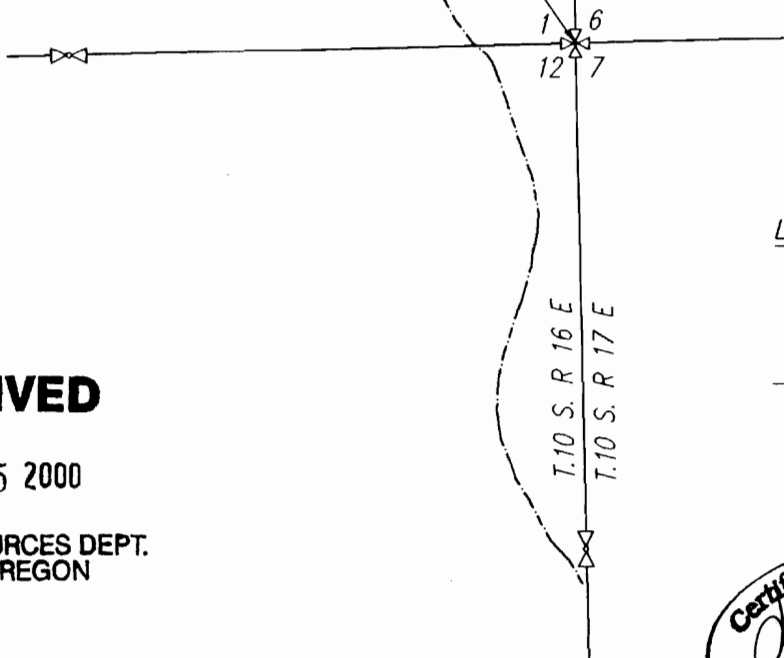

LEGEND



SECTION CORNER



QUARTER CORNER



APPROXIMATE C/L  
OF TROUT CREEK

**RECEIVED**

MAY 25 2000

WATER RESOURCES DEPT.  
SALEM, OREGON

I, Joel G. Smith, Water Rights Examiner No. 120, do hereby certify that this water rights map was prepared under my supervision.

The location of the point of diversion was measured by compass and pacing. This map is intended to show the location of the water diversion and does not accurately depict property boundaries.

This map to be read in conjunction with "Site Report" attached.

DRAWING NO: H1231-2

DATE: 5/23/00

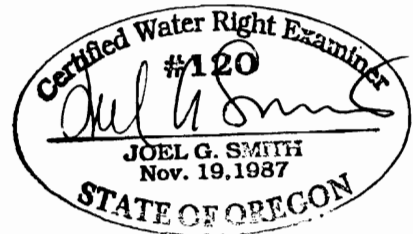

RENEWS 6/30/00

FINAL PROOF SURVEY  
DIVERSION LOCATION MAP  
CERTIFICATE NO. 2250  
SECTION 1, T10S, R 16E, WM  
JEFFERSON CO., OREGON

	TERRASCOPE, INC. 405 SW Eighth St Redmond, OR 97756 Tel: (541) 548-7852 Fax: (541) 548-7854
--	---