

# TOWNSHIP 6 SOUTH, RANGE 1 WEST, W.M.

- ① MARI 3205 (Beyer) - Orig. Well Permit G-3282
  - ② MARI 3203 (Duda) - T 4804 Add. POA
  - ③ MARI 51339 (Beyer) - T 7707 Replacement POA.
- KLW

RECEIVED

JAN 26 1999

WATER RESOURCES DEPT.  
SALEM, OREGON

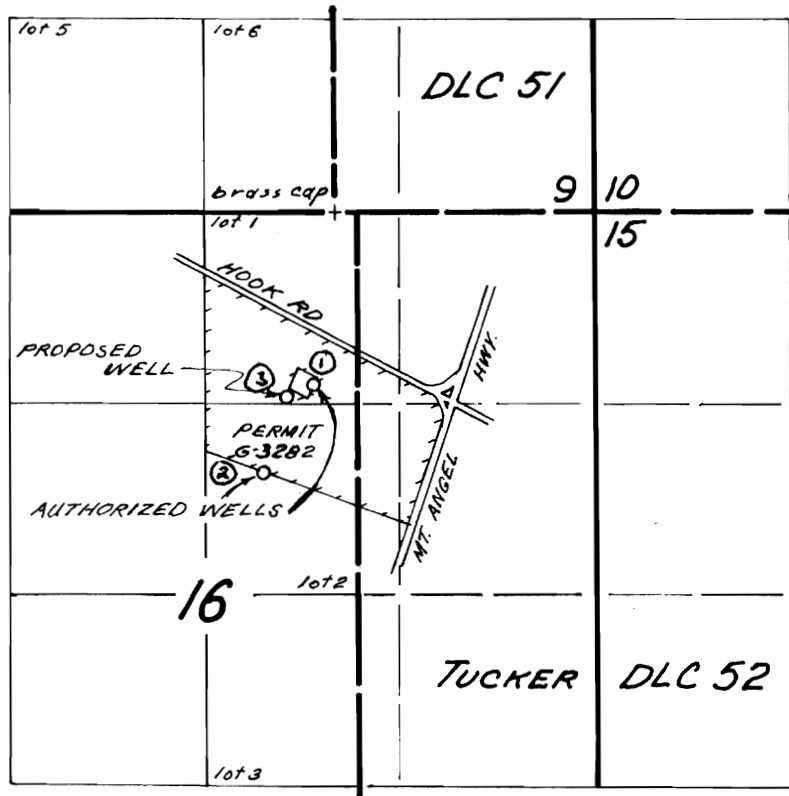

WELLS LOCATED:  
 AUTHORIZED WELLS - 1180' S. AND 140' W., 1820' S. AND 480' W.  
 PROPOSED WELL - 1280' S. AND 490' W., 730'  
 ALL FROM SW COR. DLC 51.

FINAL PROOF SURVEY

UNDER

TRANSFER 7707

IN NAME OF

JOHN BEYER

JAN. 7, 1999

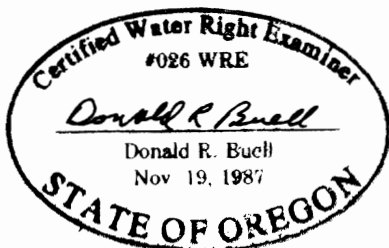

THIS MAP WAS PREPARED FOR THE PURPOSE OF IDENTIFYING THE LOCATION OF A WATER RIGHT ONLY AND IS NOT INTENDED TO PROVIDE LEGAL DIMENSIONS OR LOCATION OF PROPERTY OWNERSHIP LINES.