

RECEIVED

SEP 28 1999

WATER RESOURCES DEPT
SALEM, OREGON

WATER RIGHTS SURVEY

In The NE 1/4, SE 1/4 & SW 1/4 Section 11
& The NE 1/4 Section 14 Township 15 South,
Range 14 East, W.M., Crook County, Oregon

Wampler-Werth Farms



 = Irrigated Area

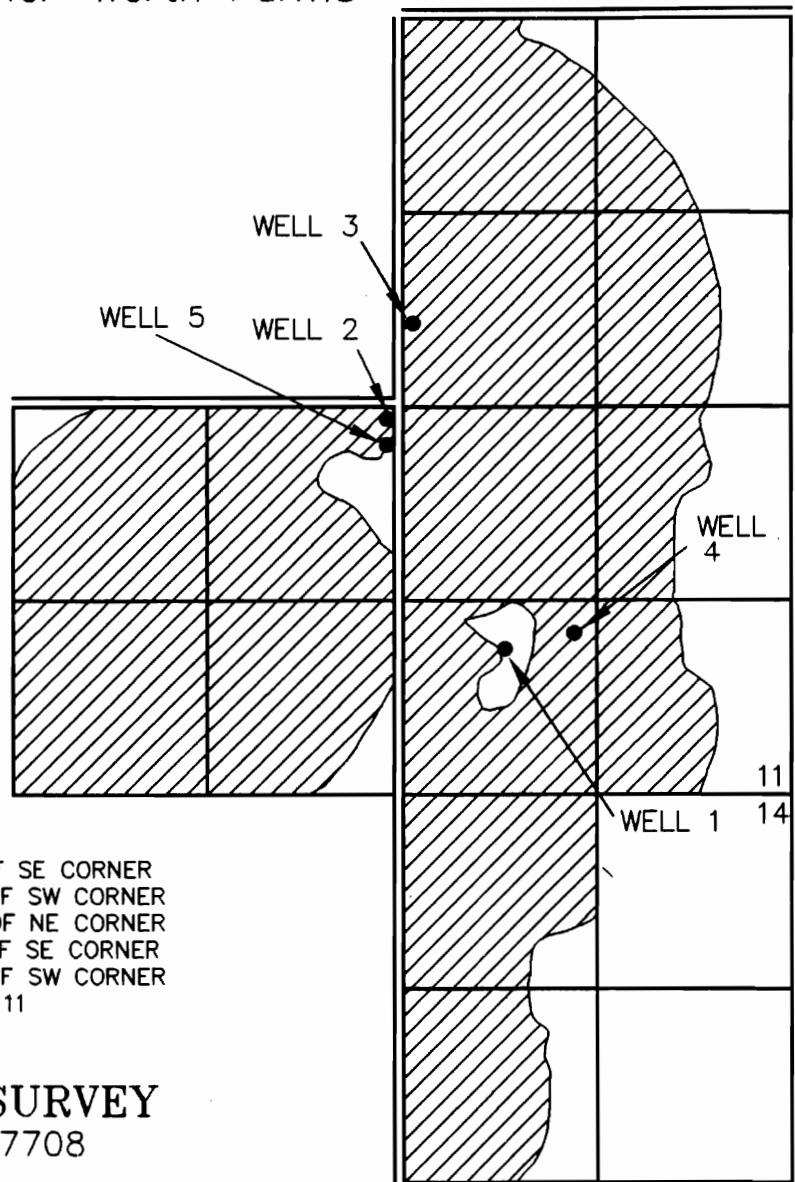

- WELL 1, 980'N. & 1950'W OF SE CORNER
 - WELL 2, 2550'N & 2550'E OF SW CORNER
 - WELL 3, 2060'S & 2600'W OF NE CORNER
 - WELL 4, 1090'N & 1480'W OF SE CORNER
 - WELL 5, 2370'N & 2550'E OF SW CORNER
- ALL IN SECTION 11

FINAL PROOF SURVEY TRANSFER NO. 7708

I, James R. Tye, Certified Water Right Examiner in the State of Oregon, hereby certify that this water rights survey map was prepared under my direct supervision.

The preparation of this map is for the purpose of identifying the location of the water right only and has no intent to provide dimensions or locations of property ownership lines.



SCALE	1"=1320'	DATE	4-30-99	SURVEY BY		DRAWN BY	S.R.K.	ORDER NO.	2472-22K
-------	----------	------	---------	-----------	--	----------	--------	-----------	----------

SUN COUNTRY ENGINEERING & SURVEYING, INC.
 920 SE ARMOUR ROAD BEND, OREGON 97702 PHONE 382-8882