

HALE - SIMPLOT
 TEMPORARY TRANSFER
 OF PERMIT G-5812 UNDER
 O.R.S. 540.523
 T3N. R28E. WM.

RECEIVED

FEB 24 1997

WATER RESOURCES DEPT
 SALEM, OREGON

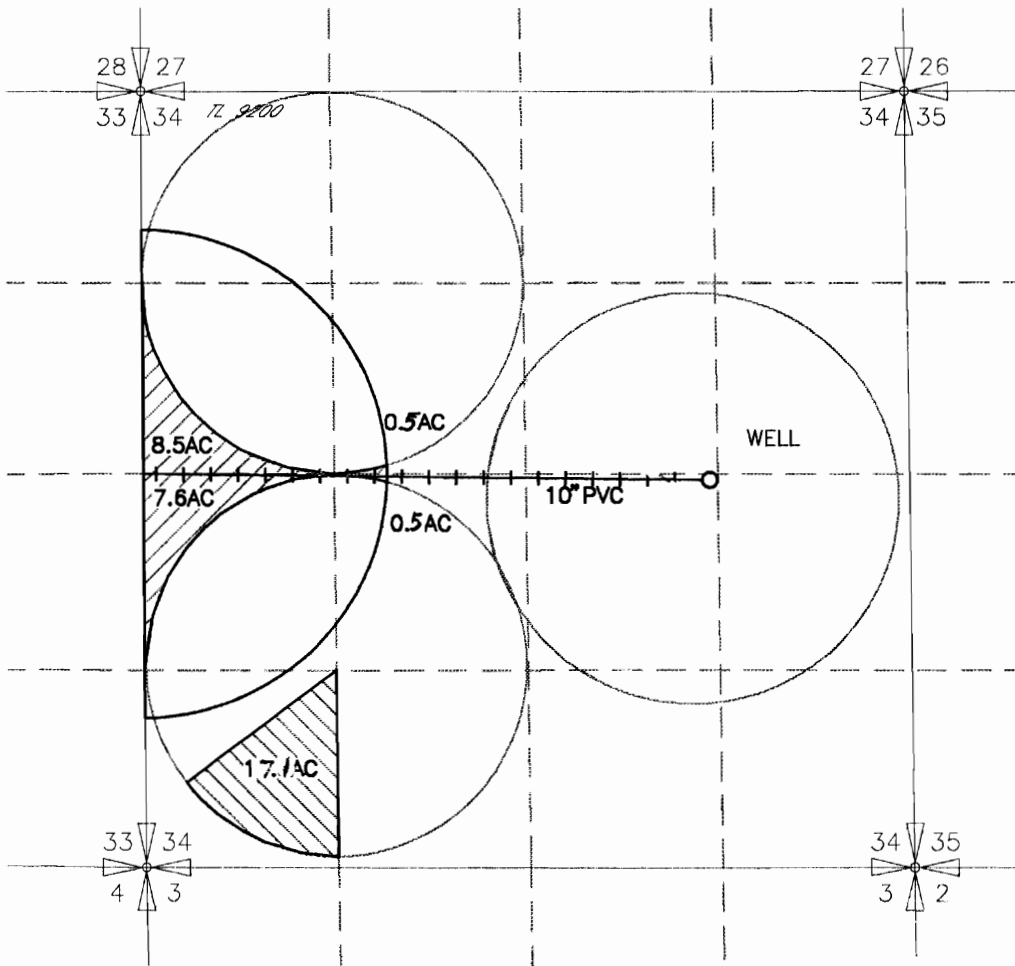

POINT OF APPROPRIATION
 LOCATED AT 1300 NORTH AND 60 WEST FROM
 THE SE CORNER NW 1/4 SE 1/4 OF SECTION 34

FROM



TO

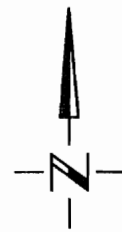

0 1320 2640



SCALE IN FEET

NOTE: THE PURPOSE OF THIS MAP IS TO IDENTIFY THE APPROXIMATE LOCATION
 OF THE WATER RIGHT. IT IS NOT INTENDED TO PROVIDE INFORMATION
 RELATIVE TO THE LOCATION OF PROPERTY OWNERSHIP BOUNDARY LINES.

T-7713

3522.054
 3522HL.DWG
 2/18/97