

T.15S., R.16E., W.M.

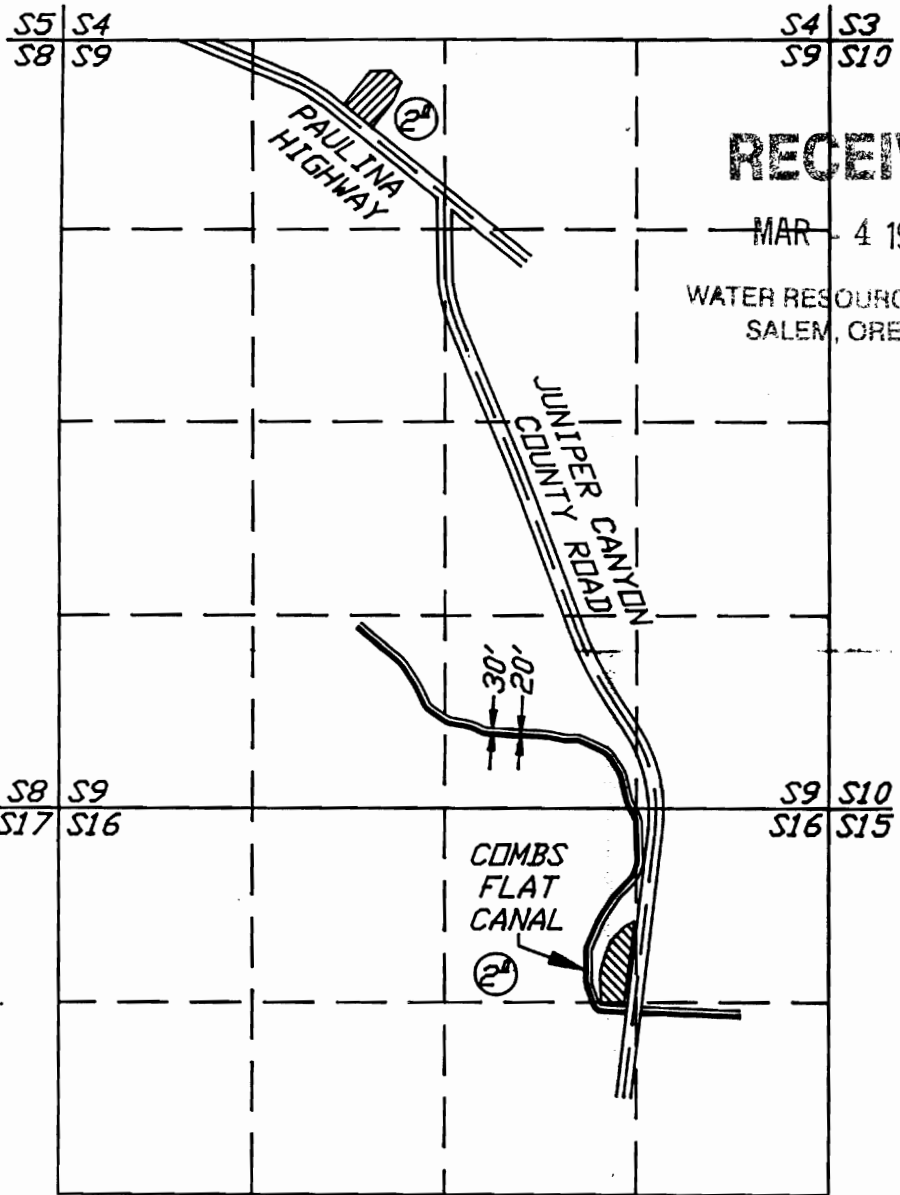

RECEIVED



MAR 4 1997

WATER RESOURCES DEPT.  
SALEM, OREGON

PREPARED FOR

DONALD ALBERT  
MARY ALICE ALBERT  
3163 S. JUNIPER  
CANYON RD.  
PRINEVILLE, OR 97754  
(541) 447-4798

LEGEND

-  WATER OFF
-  WATER ON
-  ACREAGE

NOTE

THE PREPARATION OF THIS MAP IS FOR THE PURPOSE OF IDENTIFYING THE LOCATION OF THE WATER RIGHT ONLY AND HAS NO INTENT TO PROVIDE DIMENSIONS OR LOCATIONS OF PROPERTY OWNERSHIP LINES.

Renews 12/31/97

ARMSTRONG SURVEYING  
& ENGINEERING, INC.  
378 EAST SECOND STREET  
PRINEVILLE, OR 97754  
(541) 447-7791

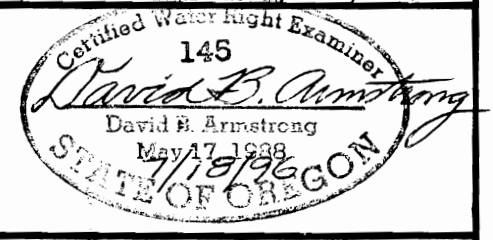

SCALE: 1" = 1320'

DATE: JUNE 24, 1996

W.D. 96-1436

T-7725