

WATER RIGHTS SURVEY

In The SE 1/4 NE 1/4 Section 11
Township 15 South, Range 14 East, W.M.,
Crook County, Oregon

Andrew & Kerrie Wallace Property
Tax Lot 109

SE 1/4 NE 1/4

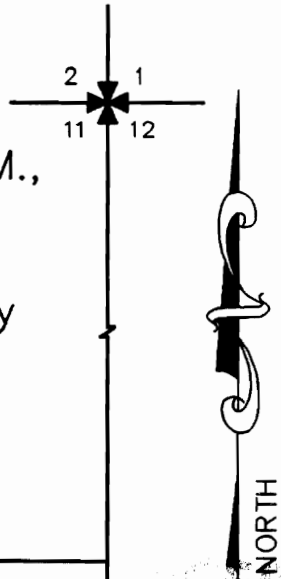

 = Irrigated Area

The existing point of diversion is in the SW 1/4 SE 1/4 Sec. 11, 1090' North and 1480' West of the SE corner of Sec. 11.

IRRIGATED AREA = 4.8 ACRES

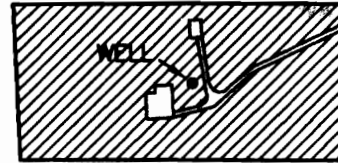

WELL IS 1796' SOUTH AND
315' WEST OF THE NE COR-
NER OF SECTION 11

APPLICATION MAP FOR ADDITIONAL POINT OF DIVERSION PERMIT NO. G-8720

I, James R. Tye, Certified Water Right Examiner in the State of Oregon, hereby certify that this water rights survey map was prepared under my direct supervision.

The preparation of this map is for the purpose of identifying the location of the water right only and has no intent to provide dimensions or locations of property ownership lines.



SCALE 1" = 400' | DATE 2-26-97 | SURVEY BY A.W. & K.W. | DRAWN BY S.R.K. | ORDER NO. 4303-22

SUN COUNTRY ENGINEERING & SURVEYING, INC.
61555 PARRELL ROAD BEND, OREGON 97702 PHONE 382-8882

T-7739