

T. 5 S. R. 1 W. W.M.

RECEIVED

MAY 17 1989

MAILED BY MAIL ROOM
DALLAS, TEXAS

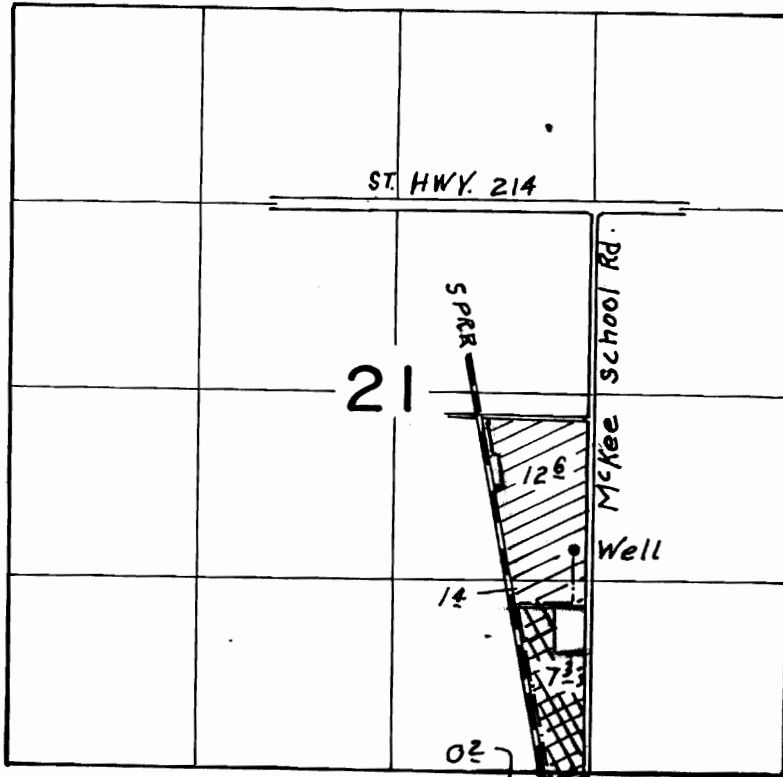

Scale
4" = 1 Mi.

Well loc. 1530' N & 1430' W from SE Cor. Sec. 21

 Ag. Use

 Irrig.

FINAL PROOF SURVEY UNDER

Transfer No. T-7632

Application No. G-13491 Permit No. G-12167. & T-7755

IN NAME OF

BOB FESSLER

Surveyed April 26 1999, by

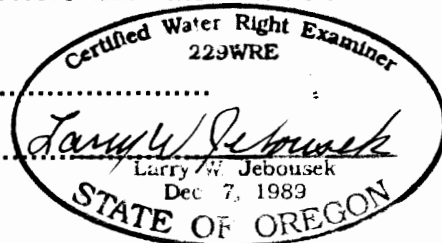

THIS MAP WAS PREPARED FOR THE PURPOSE OF IDENTIFYING THE LOCATION OF A WATER RIGHT ONLY AND IS NOT INTENDED TO PROVIDE LEGAL DIMENSIONS OR LOCATION OF PROPERTY OWNERSHIP LINES.