

1997 TEMPORARY TRANSFER L & L FARMS T. 3N. R. 28E.W.M. GROUNDWATER

RECEIVED
JAN 21 1997
WATER RESOURCES DEPT.
SALMON DIVISION

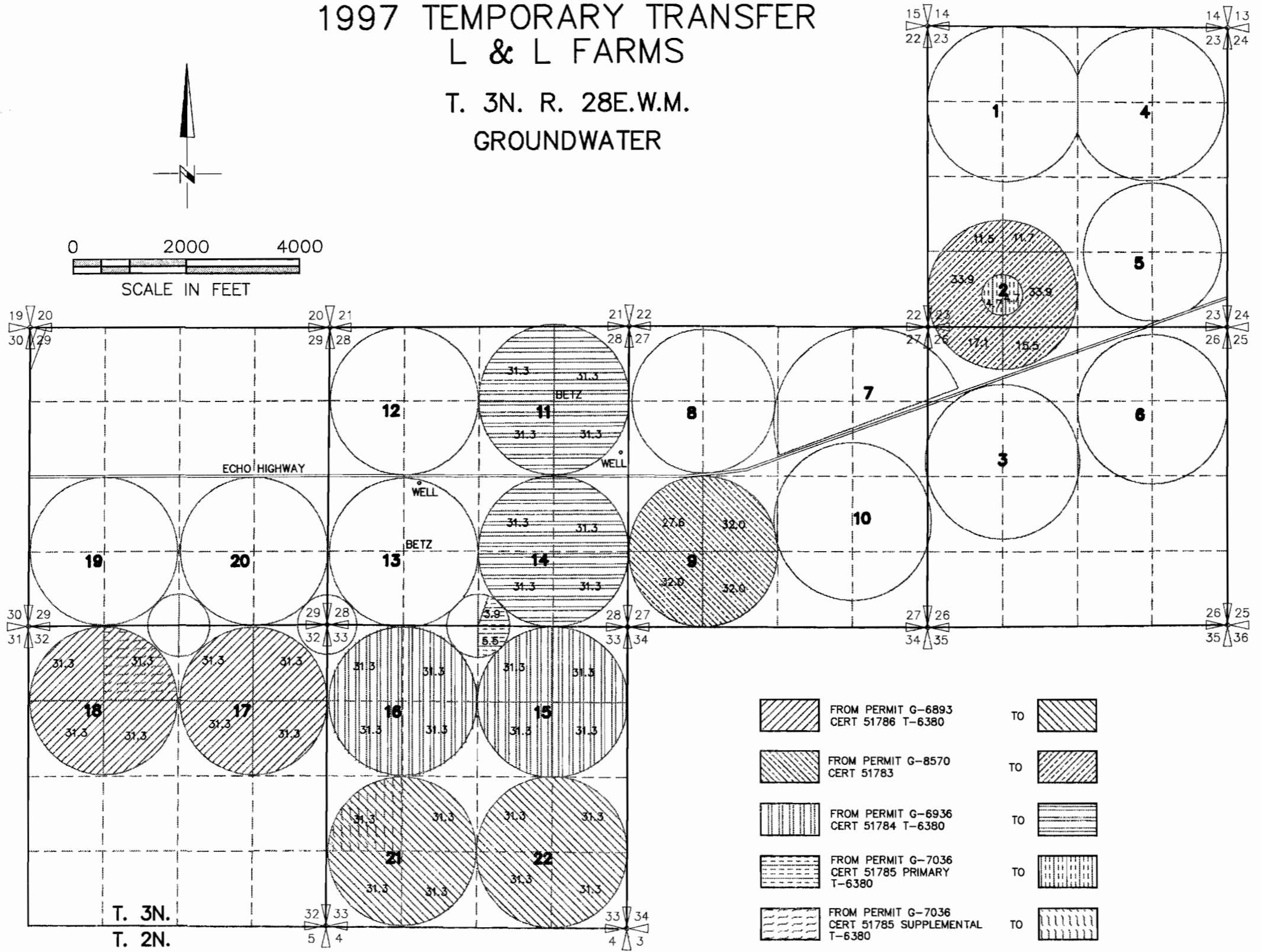

	FROM PERMIT G-6893 CERT 51786 T-6380	TO	
	FROM PERMIT G-8570 CERT 51783	TO	
	FROM PERMIT G-6936 CERT 51784 T-6380	TO	
	FROM PERMIT G-7036 CERT 51785 PRIMARY T-6380	TO	
	FROM PERMIT G-7036 CERT 51785 SUPPLEMENTAL T-6380	TO	

NOTE: THE PURPOSE OF THIS MAP IS TO IDENTIFY THE APPROXIMATE LOCATION OF THE WATER RIGHT. IT IS NOT INTENDED TO PROVIDE INFORMATION RELATIVE TO THE LOCATION OF PROPERTY OWNERSHIP BOUNDARY LINES.