

MAP TO ACCOMPANY APPLICATION
FOR A TEMPORARY WATER RIGHT TRANSFER
RICHARD C. SMITH

AUTHORIZED PLACE OF USE
SW 1/4 SECTION 25
T26S R18E WM
LAKE COUNTY, OREGON
TAX LOT 7700
Permit G-10703 Certificate 75867

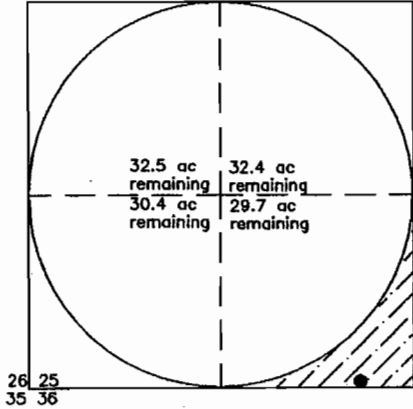

26 25
35 36

Authorized POA (well) is located 30' North and 3000' West of the SE Section Corner Section 25 (SE1/4 SW1/4)



10.3 ac to transfer from
P G-10703 C 75867

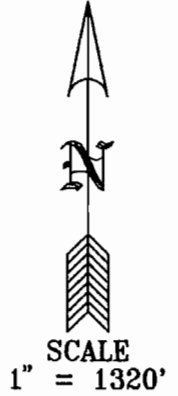

PROPOSED PLACE OF USE
NW 1/4 SECTION 8
T27S R19E WM
LAKE COUNTY, OREGON
TAX LOT 700

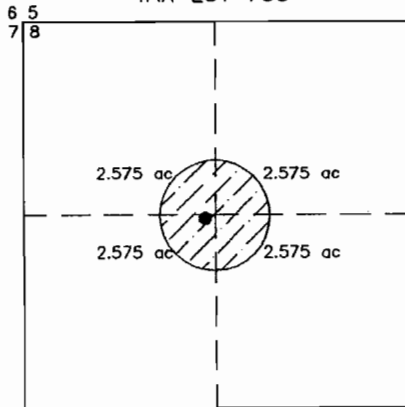

6 5
7 8

Proposed POA (well) is 1330' South and 1305' East of the NW Section Corner of Section 8 (SW1/4 NW1/4)

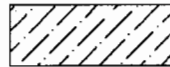

10.3 ac to transfer to

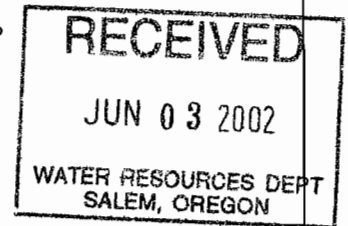

PREPARED BY: SUNDET & ASSOCIATES
P.O. BOX 1228
LAKEVIEW, OR 97630
541-947-3293
APRIL 2002 DRAWING #14902



Renews 6/30/02

T-9140