

JAN 21 1999

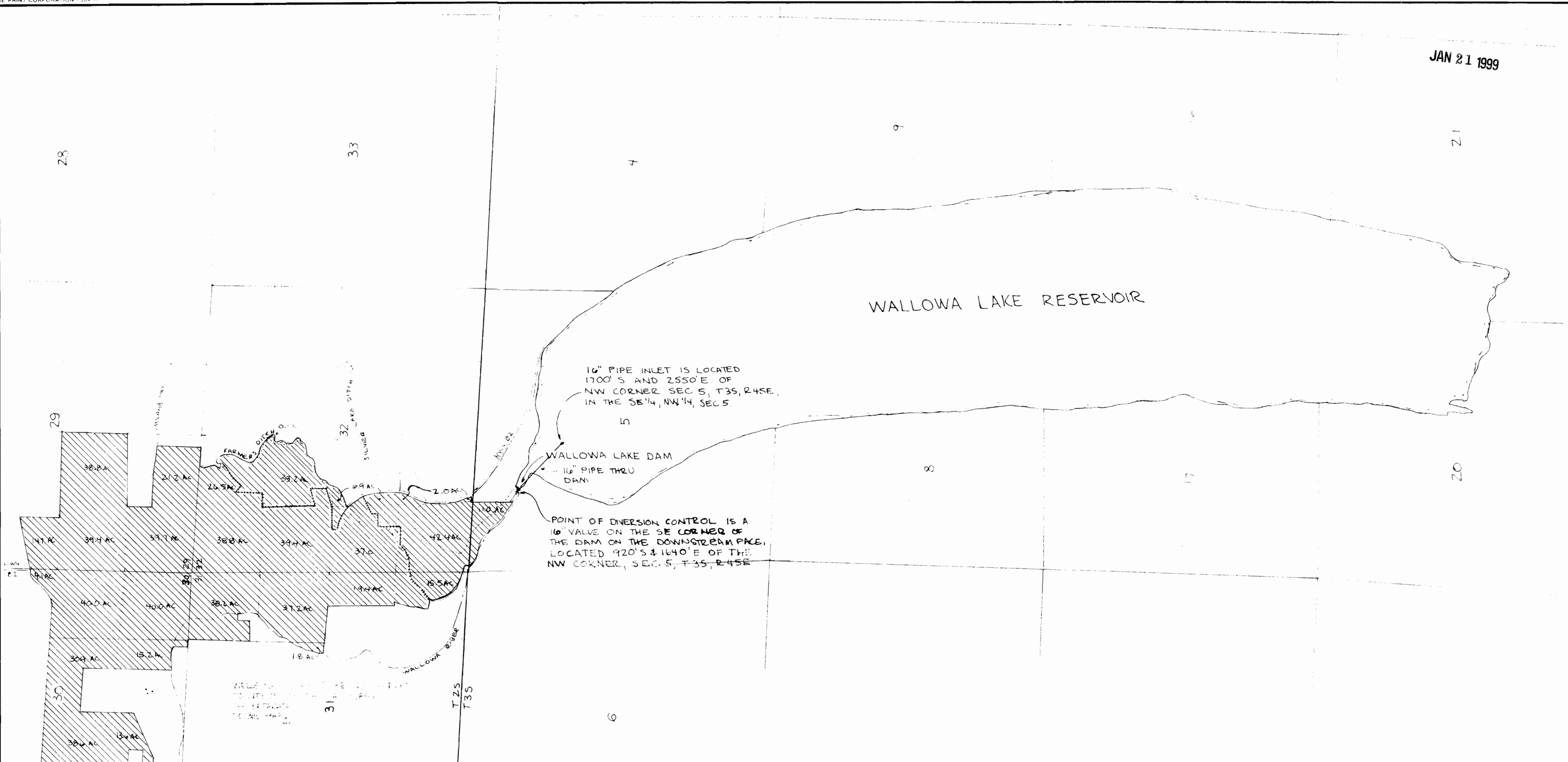

AREAS WITHIN THE CURRENT URBAN GROWTH BOUNDARY:

T 25, R 45E, W.M.	SEC 29	SW 1/4, NW 1/4	14.7 AC.
		NE 1/4, SW 1/4	38.8
		NN 1/4, SW 1/4	39.4
		SW 1/4, SW 1/4	39.7
		SE 1/4, SW 1/4	21.2
SEC 30		SE 1/4, NE 1/4	4.1 AC.
		NE 1/4, SE 1/4	40.0
		NN 1/4, SE 1/4	30.9
		SW 1/4, SE 1/4	15.2
		SE 1/4, SE 1/4	40.0
		NE 1/4, SW 1/4	38.6
		NN 1/4, SW 1/4	3.2
		SE 1/4, SW 1/4	15.2
SEC 31		NE 1/4, NE 1/4	38.2 AC.
		SW 1/4, NE 1/4	1.8
		SE 1/4, NE 1/4	37.2
		NE 1/4, SE 1/4	19.4
		SE 1/4, SE 1/4	15.5
SEC 32		NE 1/4, NW 1/4	26.5 AC.
		NN 1/4, NW 1/4	38.8
		SW 1/4, NW 1/4	39.4
		SE 1/4, NW 1/4	35.2
		SW 1/4, NE 1/4	0.1
		NE 1/4, SW 1/4	6.9
		NN 1/4, SW 1/4	37.0
		SW 1/4, SW 1/4	42.4
		SE 1/4, SW 1/4	2.0
		T 35, R 45E, W.M.	SEC 5

HATCHED AREA REPRESENTS THE PLACE OF USE - ALL AREAS ARE WITHIN THE CITY OF JOSEPH CITY LIMITS AND/OR URBAN GROWTH BOUNDARIES.

--- INDICATES CITY LIMIT LINE INSIDE URBAN GROWTH BOUNDARY. FOR ALL OTHER LOCATIONS EXTERIOR BOUNDARY OF HATCHED AREA IS THE CITY LIMIT LINE.

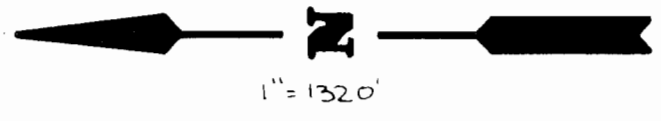

BASIS OF MAP IS 1990 JOSEPH, OREGON ORTHOPHOTO QUAD MAP, AERIAL PHOTOS, AND COUNTY ASSESSOR MAPS. IT IS PREPARED FOR WATER RIGHT PURPOSES ONLY, AND SHOULD NOT BE USED FOR PROPERTY LOCATION PURPOSES.

T 2634

THE PURPOSE OF THIS APPLICATION IS TO TRANSFER 480 A.F. OF STORED WATER RIGHTS HELD BY THE ASSOCIATED DITCH COMPANY, CONSISTING OF THE SILVER LAKE DITCH, FARMERS DITCH, BIG BEND, CREIGHTON, WRENN & DOBBIN, AND McCUBBIN-CRAIG DITCHES TO THE CITY OF JOSEPH FOR MUNICIPAL USE, AND TO APPROPRIATE WATER FOR MUNICIPAL USE WITHIN THE CITY OF JOSEPH URBAN GROWTH BOUNDARY (URBAN SERVICE AREA.

T 17853

THE PURPOSE OF THIS MAP IS TO SHOW THE NEW PLACE OF USE FOR WELLS TRANSFERRED TO CITY OF JOSEPH FOR MUNICIPAL USE.

*Ralph S. Smeeth*

CITY OF JOSEPH - IN WALLOWA CO.			
STORAGE RIGHT TRANSFER AND SURFACE WATER APPROPRIATION APPLICATION; PLACE OF USE FOR WELL WATER TRANSFER			
DATE 9/96	WALLOWA MOUNTAIN ENGINEERING 200 BEAUMONT ENTERPRISE, OREGON 97114 426 4085	REVISIONS 1 99	SHEET 1 OF 1
JOB 967104			
DESIGN RWS			
DRAWN RWS			