

TEMPORARY TRANSFER APPLICATION MAP FOR MIKAMI BROS FARM UNDER PERMIT 37121 T4N, R30E WM

T-7860

R29E WM
R30E WM

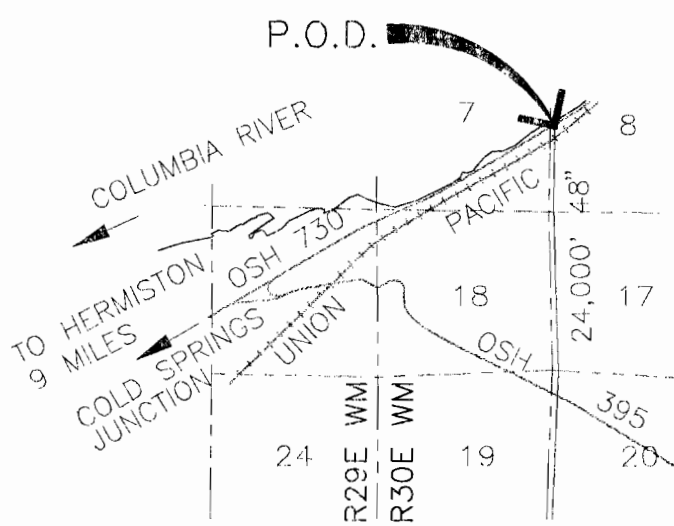
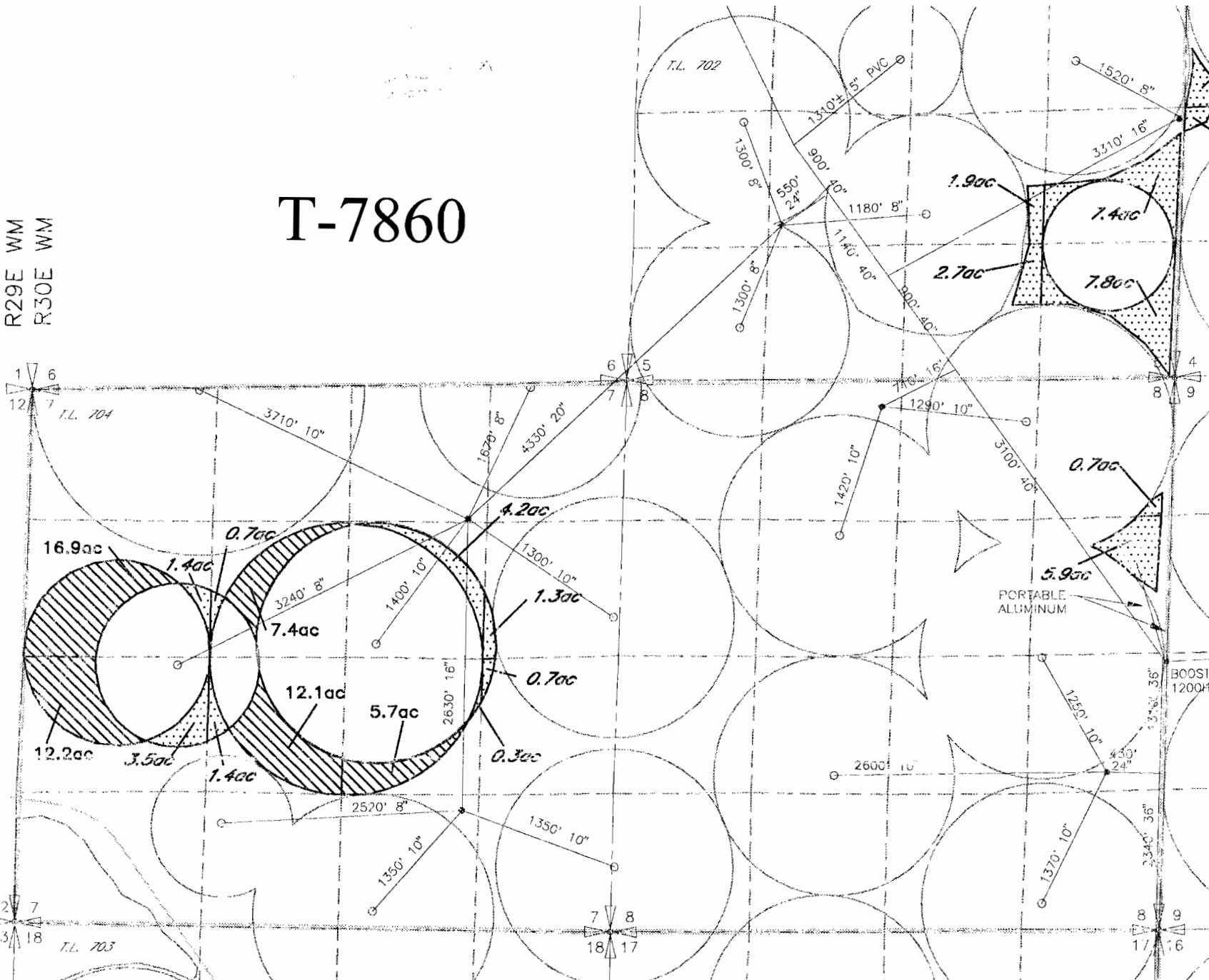

 FROM

 TO

COLUMBIA RIVER
DIVERSION POINT LOCATED
2910ft NORTH AND 120ft
EAST FROM THE SW CORNER
SECTION 8., T.5N., R.30E. WM

