



MAR 24 1998
WATER RESOURCES DEPT.
SALEM, OREGON

HALE - SIMPLOT 1998 TEMPORARY TRANSFER OF PERMIT G-5812, CERTIFICATE 51295 UNDER O.R.S. 540.523 T3N. R28E. WM.

 FROM
 AREA NOT INVOLVED IN
FORMAL TRANSFER T-7197
NO ORDER ISSUED.

TO

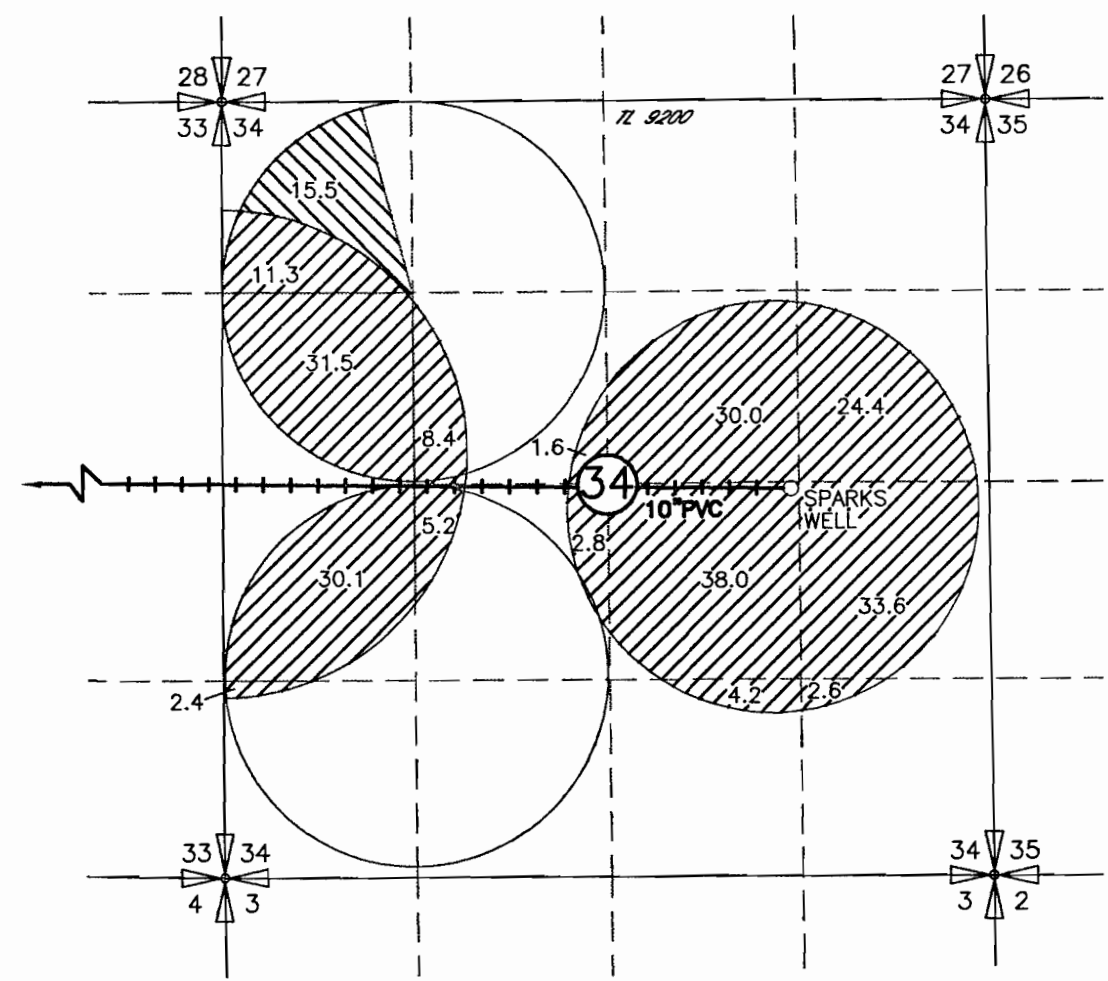
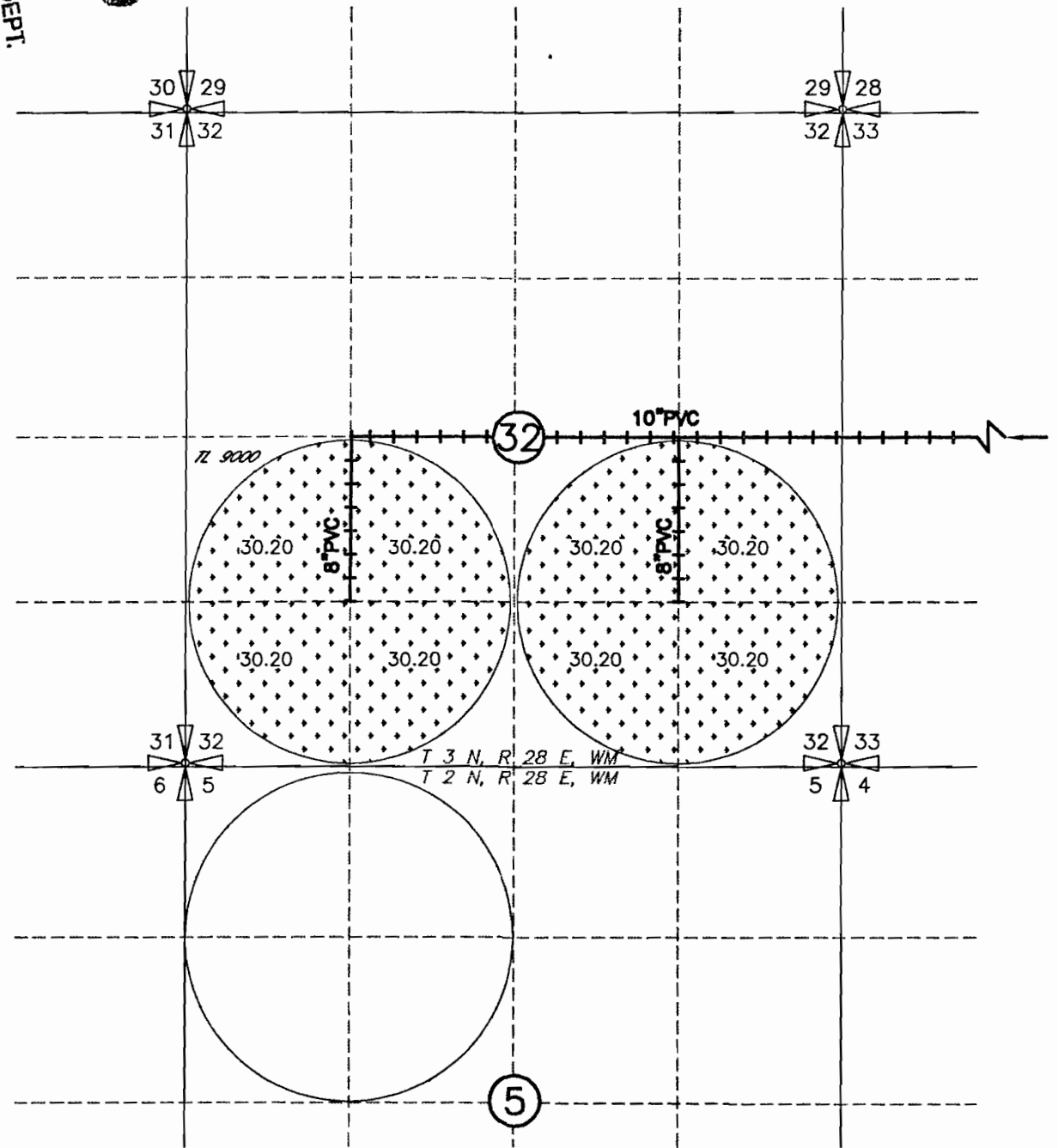

POINT OF APPROPRIATION - SPARKS WELL
LOCATED AT 1300 NORTH AND 60 WEST FROM
THE SE CORNER NW 1/4 SE 1/4 OF SECTION 34

POINT OF APPROPRIATION - SPARKS WELL
LOCATED AT 1300 NORTH AND 60 WEST FROM
THE SE CORNER NW 1/4 SE 1/4 OF SECTION 34

NOTE: THE PURPOSE OF THIS MAP IS TO IDENTIFY THE APPROXIMATE LOCATION
OF THE WATER RIGHT. IT IS NOT INTENDED TO PROVIDE INFORMATION
RELATIVE TO THE LOCATION OF PROPERTY OWNERSHIP BOUNDARY LINES.

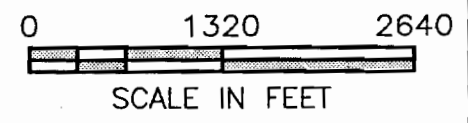

T-7964