

TEMPORARY TRANSFER APPLICATION MAP FOR MIKAMI BROS FARM UNDER PERMIT 37833 T4N, R30E WM

RECEIVED

MAR 30 1998

T 7968

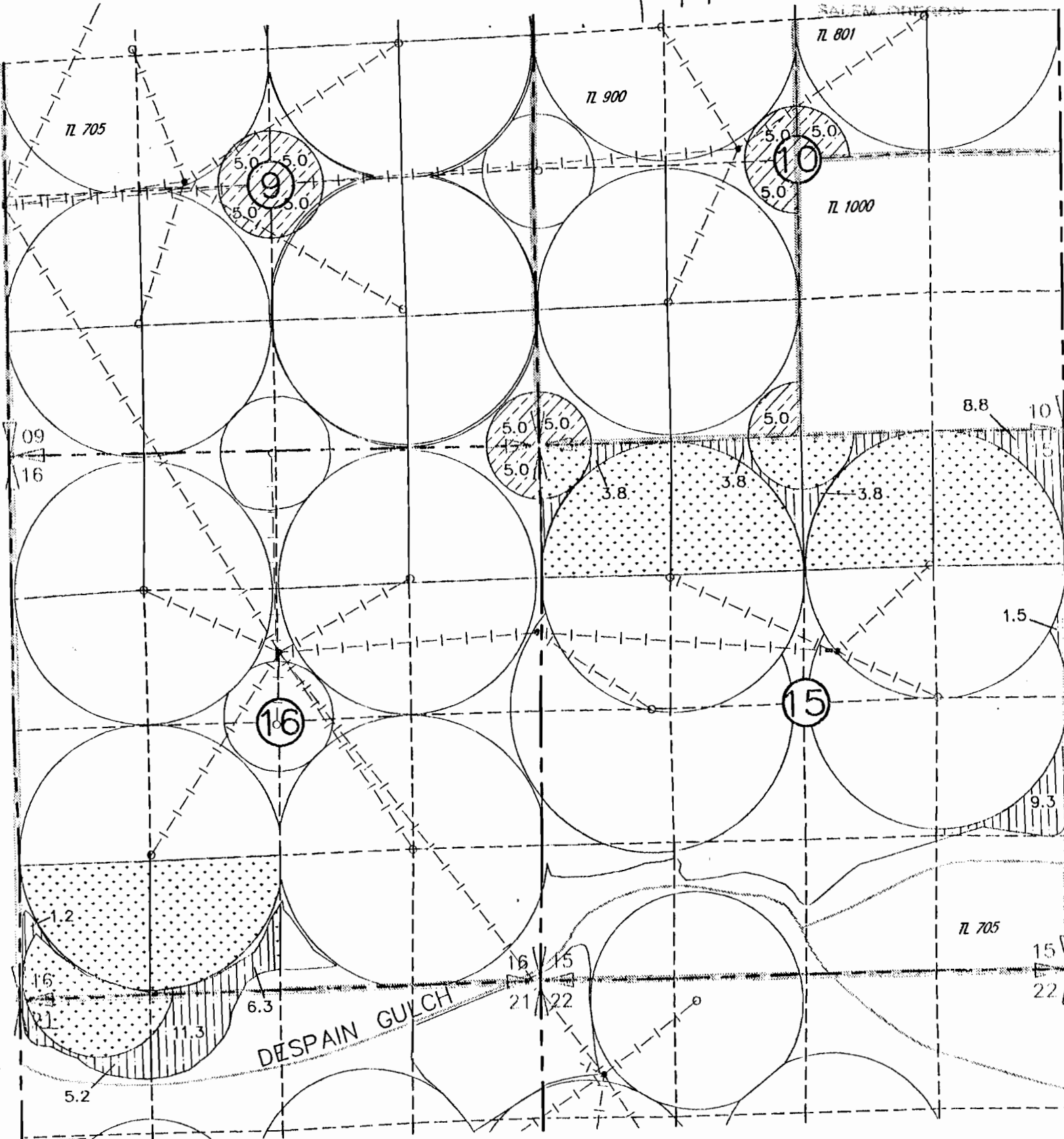

- FROM
- TO
- AREAS OF PERMIT 37833 NOT INVOLVED IN THIS TRANSFER

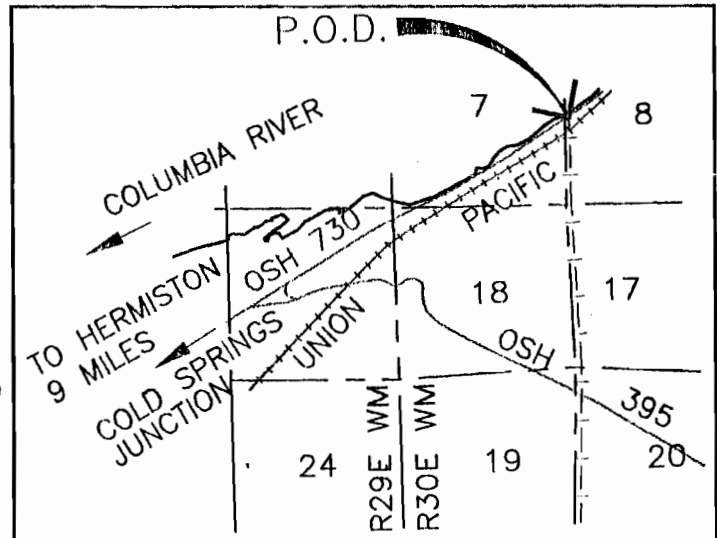

COLUMBIA RIVER DIVERSION POINT LOCATED 2910ft NORTH AND 120ft EAST FROM THE SW CORNER SECTION 8., T.5N., R.30E. WM



NOTE:
THE PURPOSE OF THIS MAP IS TO IDENTIFY THE APPROXIMATE LOCATION OF THE WATER RIGHT. IT IS NOT INTENDED TO PROVIDE INFORMATION RELATIVE TO THE LOCATION OF PROPERTY OWNERSHIP BOUNDARY LINES.

3/4/98
2437.010
2437TMP.DWG

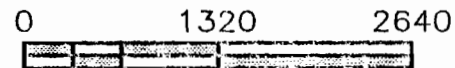

SCALE IN FEET