

T. 5 S., R. 3 W. WM.

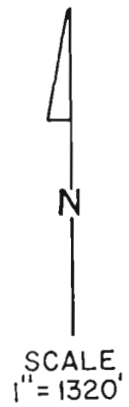
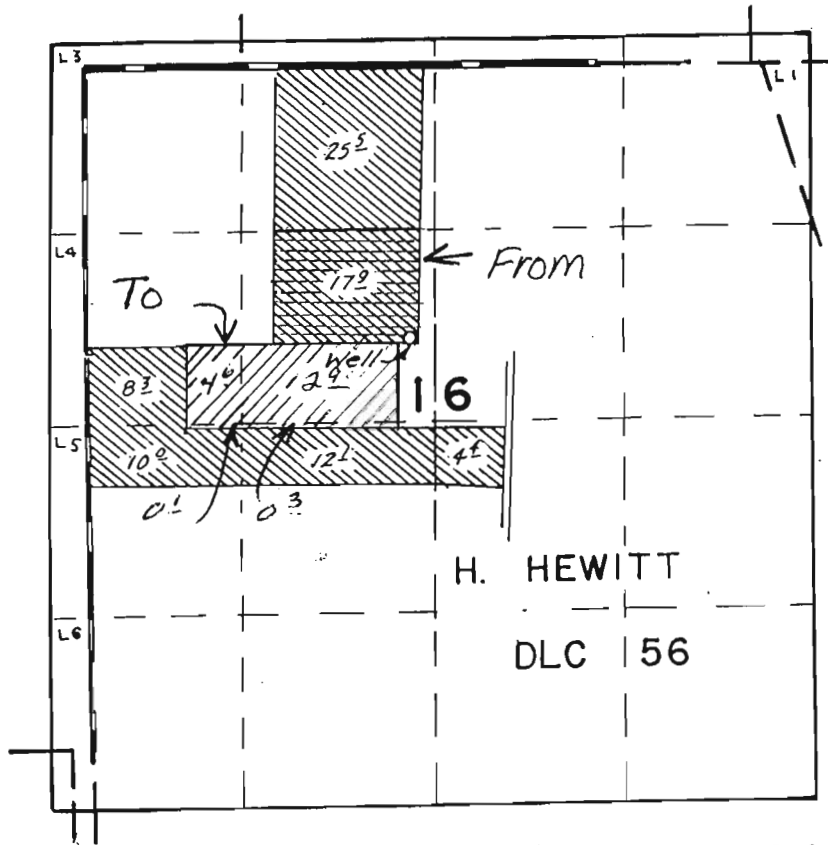

WELL LOC.: 1890' S. & 2230' E. OF NW COR. DLC 56

MAP FOR
 TEMPORARY TRANSFER
 FOR
 Kuhn to Finnicum
 2001 Season

RECEIVED
 MAR 6 2001
 WATER RESOURCES DEPT.
 SALEM, OREGON