

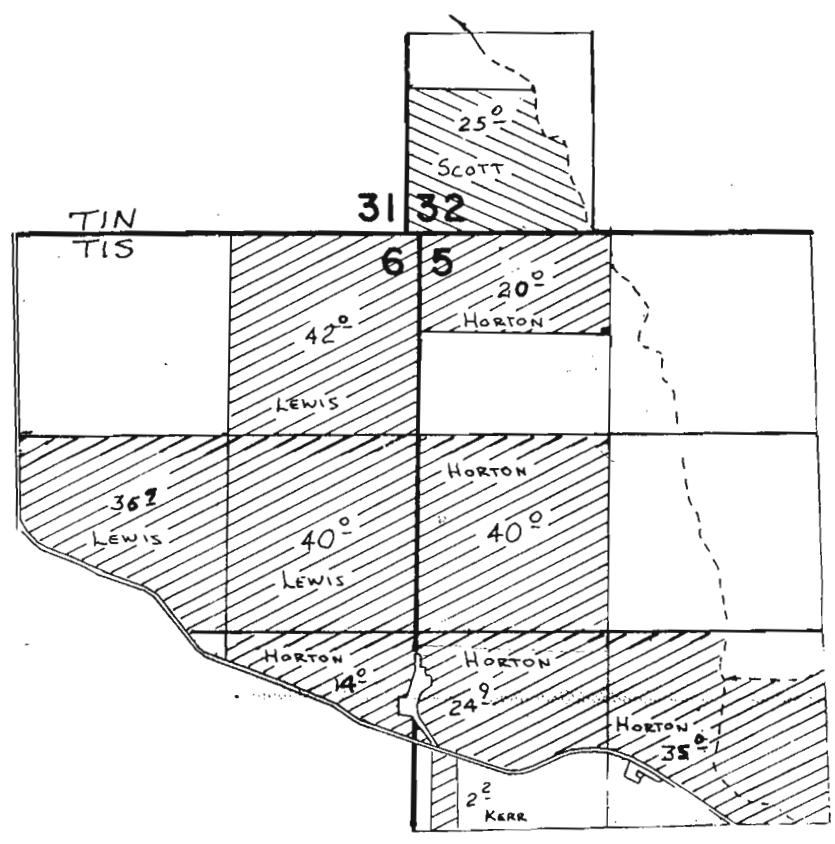

T-8789

T.1N. & IS., R.43E., W.M.



-  PRIMARY
-  SUPPLEMENTAL

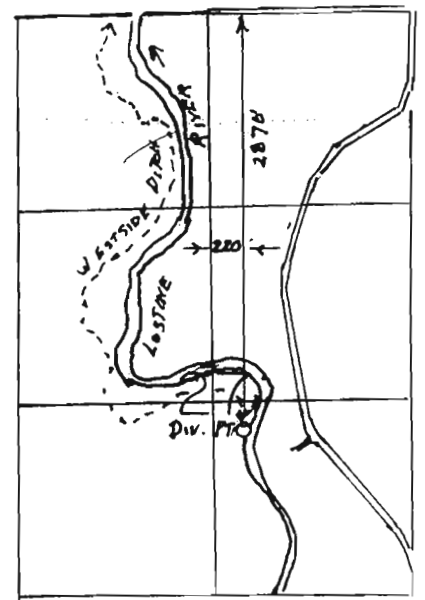

FINAL PROOF SURVEY UNDER

Application No. 50421 Permit No. 38052
IN NAME OF

ALLEN CANYON SPRINKLER ASSOC.

Surveyed 8-12-1982, by V.L. Church

RECEIVED

MAY 03 2001

WATER RESOURCES DEPT
SALEM, OREGON