

SCALE: 1" = 1320'

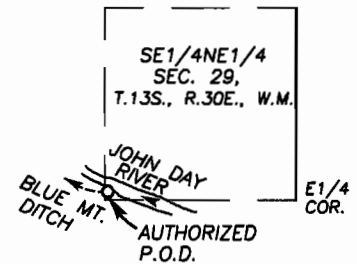

ADDITIONAL DIV. PT. IS 740' S. AND 1260' W. OF THE NE COR. SEC. 26

AUTHORIZED DIV. PT. IS 80' N. AND 1310' W. OF THE E1/4 COR. SEC. 29, T13S, R30E - C-65852

**FINAL PROOF SURVEY**  
UNDER TRANSFER NO. T-9332  
SPECIAL ORDER VOL. 60, PAGE 839  
FOR  
**ADDITIONAL POINT OF DIVERSION**  
IN NAME OF  
**STEVE & CAROL WALKER**

SURVEYED BY ROBERT D. BAGETT  
BAGETT-GRIFFITH & BLACKMAN  
217 N. CANYON BLVD.  
JOHN DAY, OREGON  
(541) 575-1251

SEPTEMBER 7, 2005

T.L. TAX LOT

● FOUND BRASS CAP MONUMENT

○ EXISTING PUMP

----- EXISTING MAINLINE

▨ PLACE OF USE  
C-65852

NOTE: THE PREPARATION OF THIS MAP WAS FOR THE PURPOSE OF IDENTIFYING THE LOCATION OF THE PROPOSED WATER RIGHT AND HAS NO INTENT TO PROVIDE DIMENSIONS OR LOCATION OF PROPERTY OWNERSHIP LINES.

RECEIVED

SEP 28 2005

WATER RESOURCES DEPT  
SALEM, OREGON

