

T-8427

TOWNSHIP 6 SOUTH, RANGE 1 WEST, W.M.

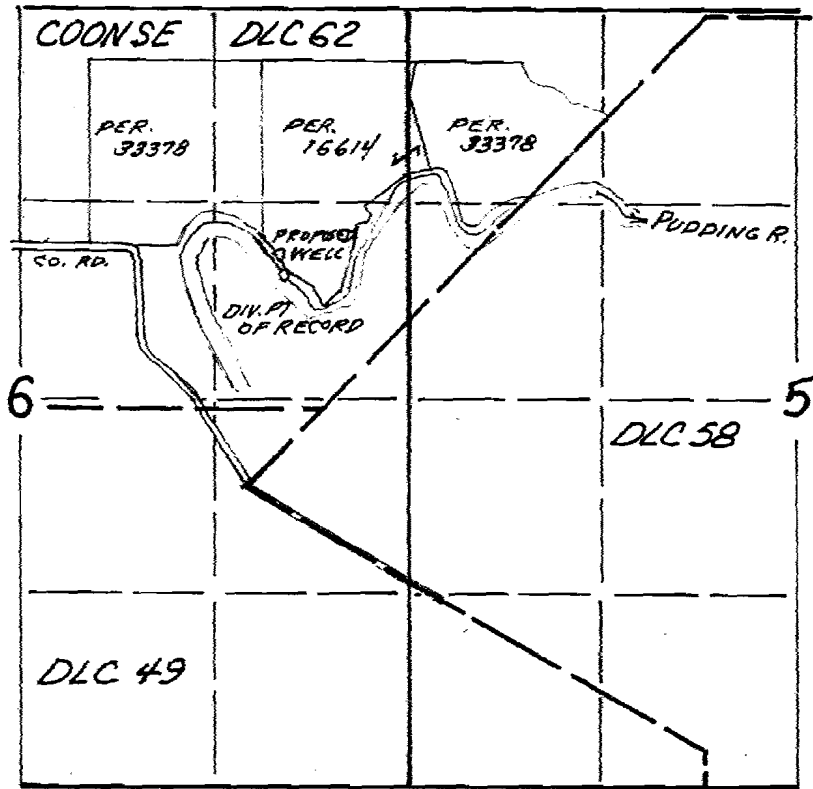

DIV. PT. OF RECORD LOCATED 900' N. & 240' W.
 PROPOSED WELL LOCATED 1000' N. & 270' W.
 BOTH FROM SE COR. COONSE DLC 62.

RECEIVED

JAN 27 2000

WATER RESOURCES DEPT.
SALEM, OREGON

MAP TO ACCOMPANY
 TRANSFER APPLICATION
 IN NAME OF
 EDER FARMS, INC.

TRANS. No. _____

