

RECEIVED

NOV 10 2004

WATER RESOURCES DEPT
SALEM, OREGON

FINAL PROOF SURVEY MAP

T 6 2 R 3 W, W.M.

Prepared for Miller Forests, Inc. under T-9377

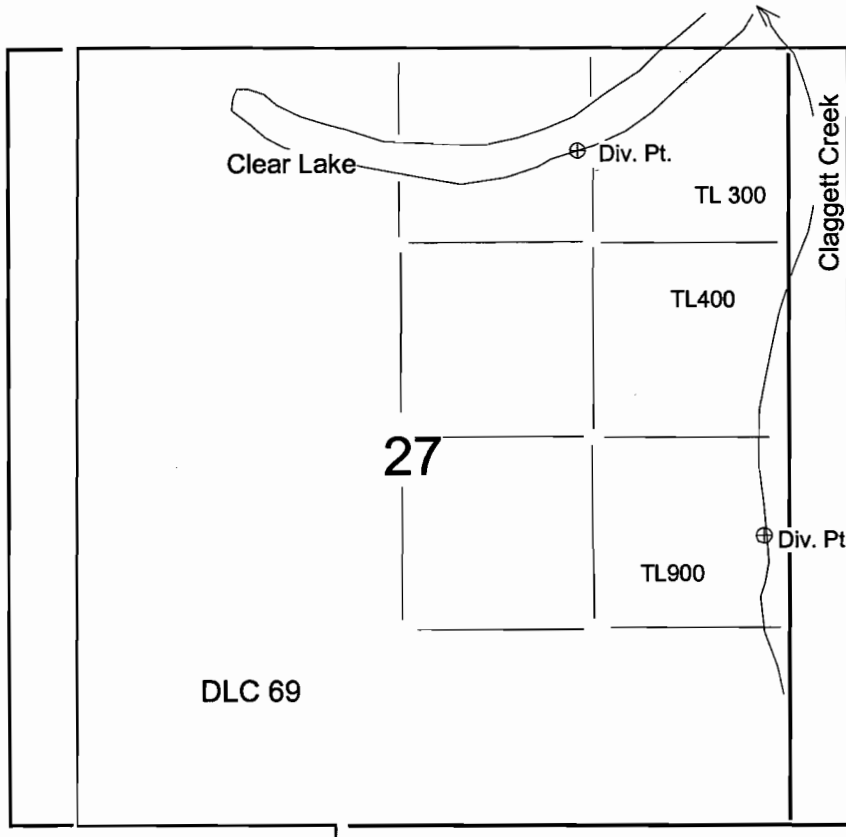

Clear Lake Div. Pt.: 700' S & 1825' W from the NE corner DLC 69
Claggett Cr. Div. Pt.: 660' S & 150' W from the E 1/4 corner Sec 27

4" = 1 mile



0

2500

This map is for water
right purposes only.

